

INFORMATION ONLY

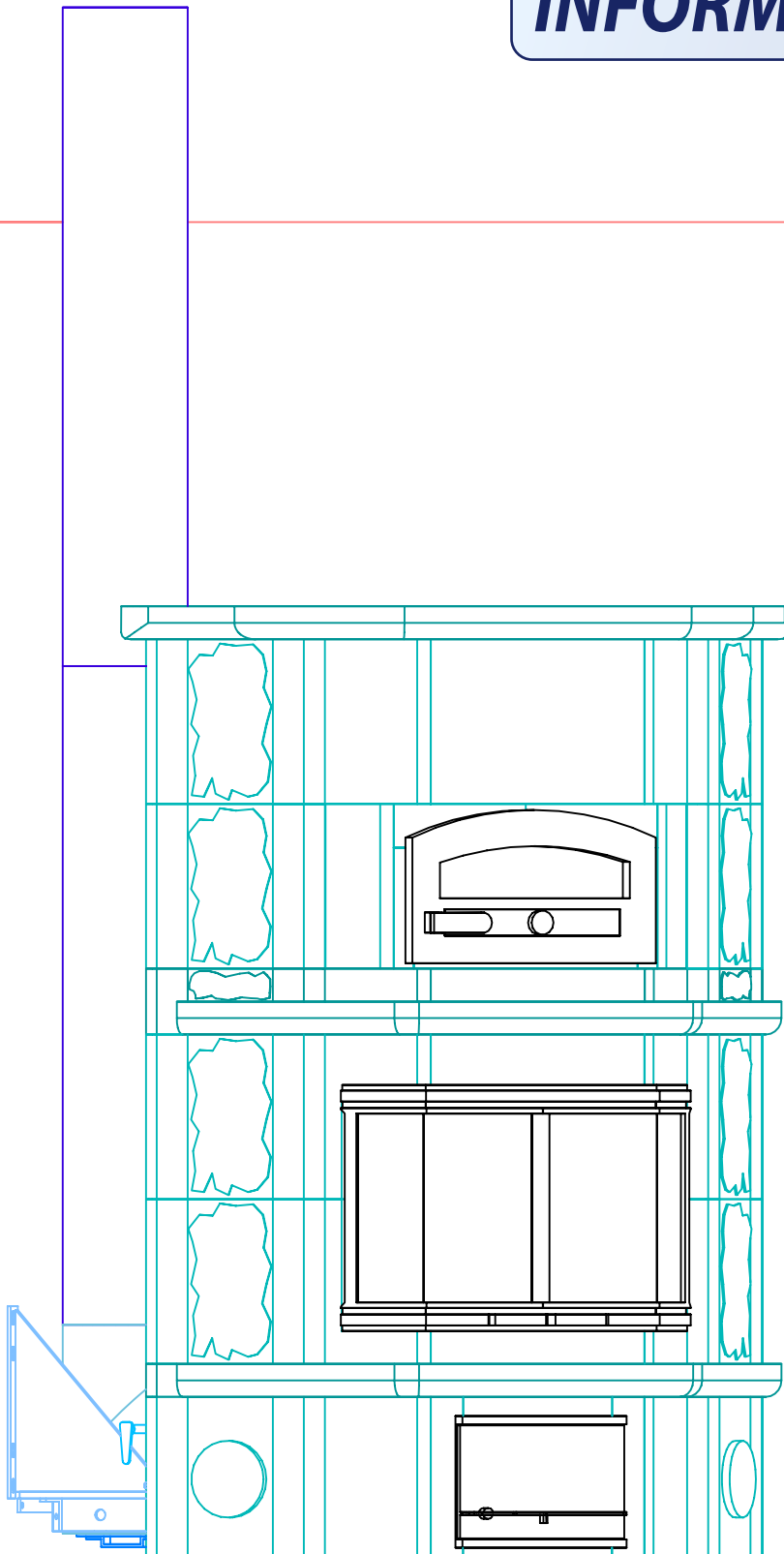

Note: Hearth Tiles CUT AND INSTALLED by others.



CORNERSTONE MASONRY
P.O. Box 83
Pray, MT 59065
(800)321-7010 Fax 406-333-4383

PROJECT GRIFFIT
MODEL KTLU2030/1

CONTRACT
DRAWN BY D.P.BYRAM

VIEW PERSPECTIVE
DATE 5/19/04

PAGE 1

Front View

INFORMATION ONLY

← 7" I.D./9" O.D. Double Wall
Stainless Steel Flue Pipe
by others
MINIMUM 2" Clearance
to Combustibles.

Damper
Control →

1740mm [68.5in]

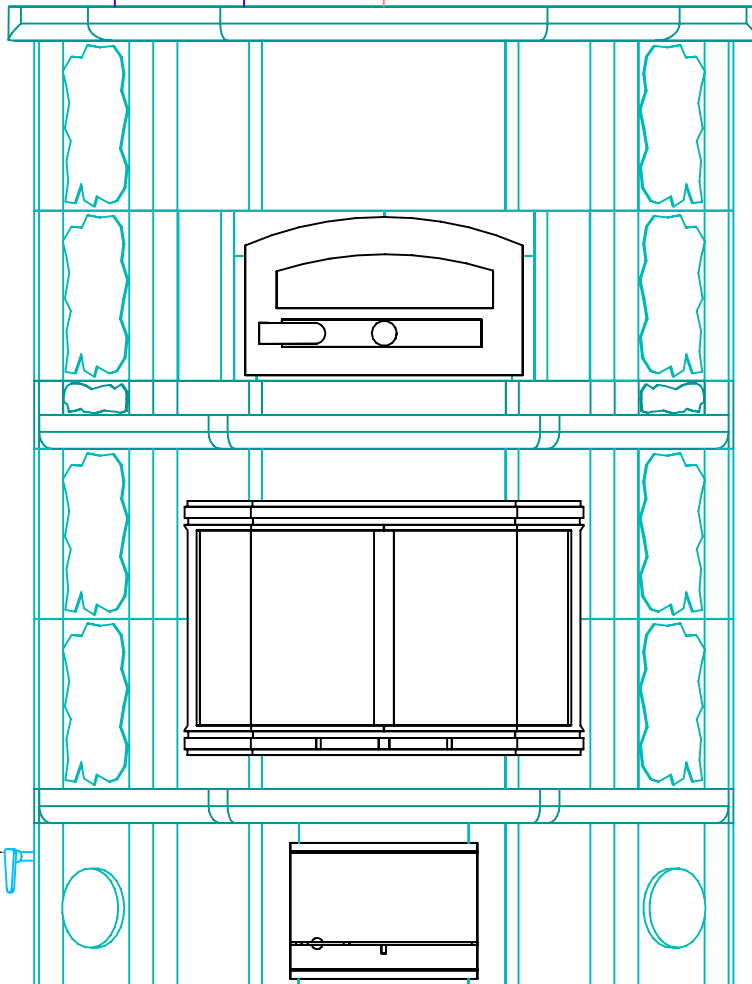

Side View

INFORMATION ONLY

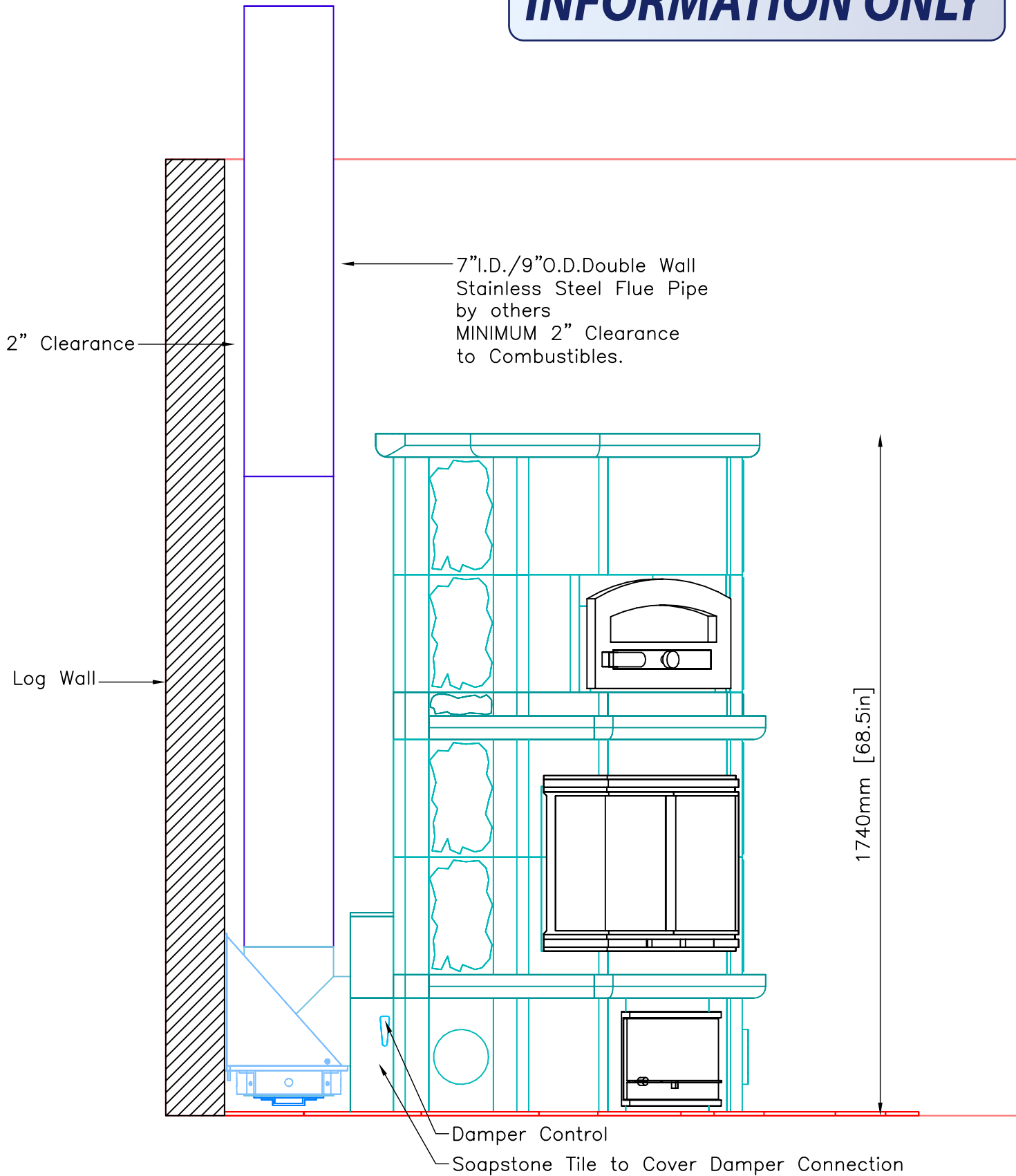

2" Clearance

7" I.D./9" O.D. Double Wall
Stainless Steel Flue Pipe
by others
MINIMUM 2" Clearance
to Combustibles.

Log Wall

1740mm [68.5in]

Damper Control
Soapstone Tile to Cover Damper Connection

Note:
MINIMUM 17" Clearance from Side of Fireplace
to Combustible materials.

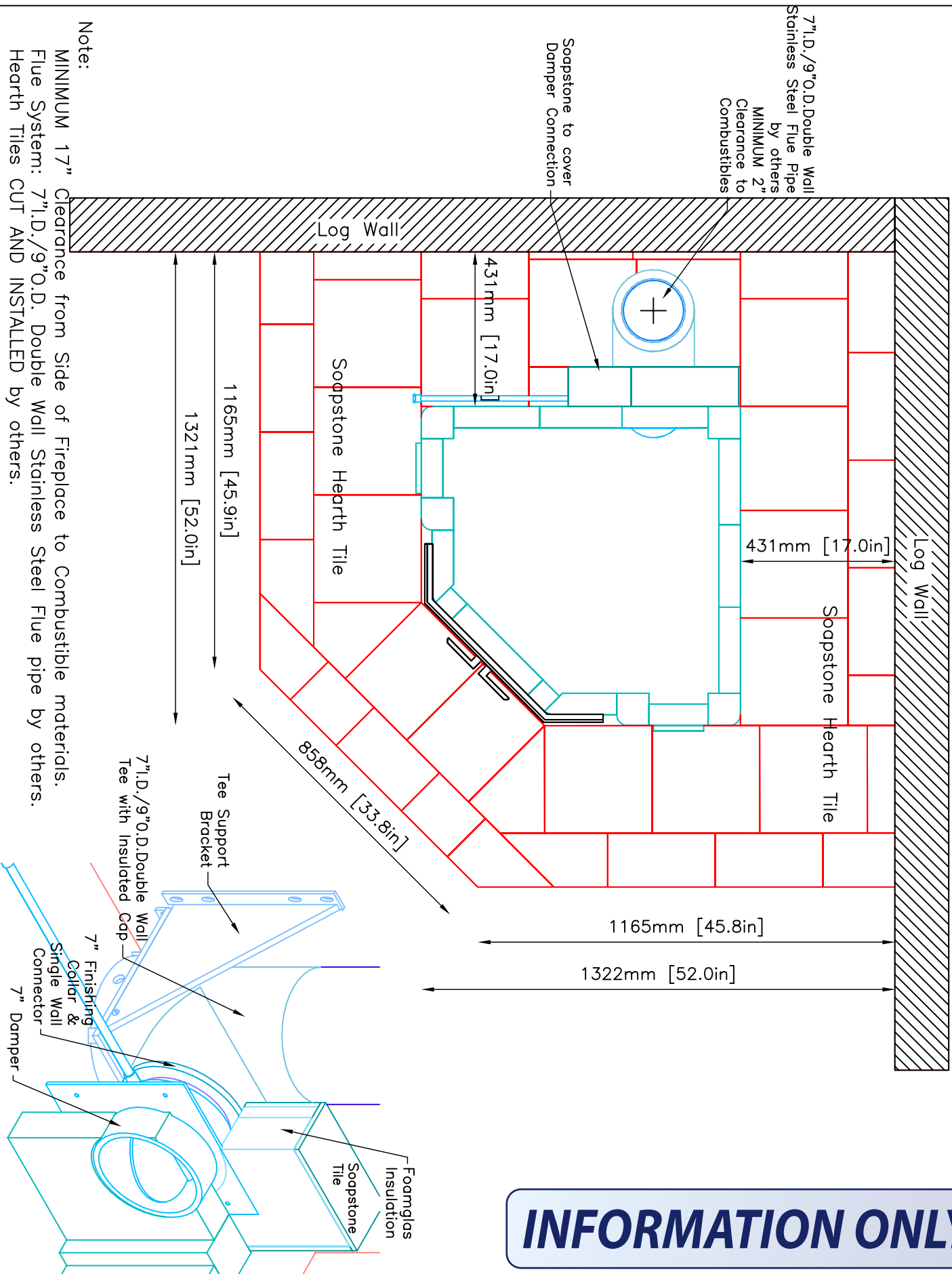

Note:
 MINIMUM 17" Clearance from Side of Fireplace to Combustible materials.
 Flue System: 7" D./9" O.D. Double Wall Stainless Steel Flue pipe by others.
 Hearth Tiles CUT AND INSTALLED by others.

INFORMATION ONLY



CORNERSTONE MASONRY
 P.O. Box 83
 Pray, MT 59065
 (800)321-7010 Fax 406-333-4383

PROJECT GRIFFIT
 MODEL KTLU2030/1

CONTRACT
 DRAWN BY D.P.BYRAM

VIEW PLAN
 DATE 5/19/04

PAGE 4

FOUNDATION SLAB:
Minimum Dimensions--2" from Base of Unit

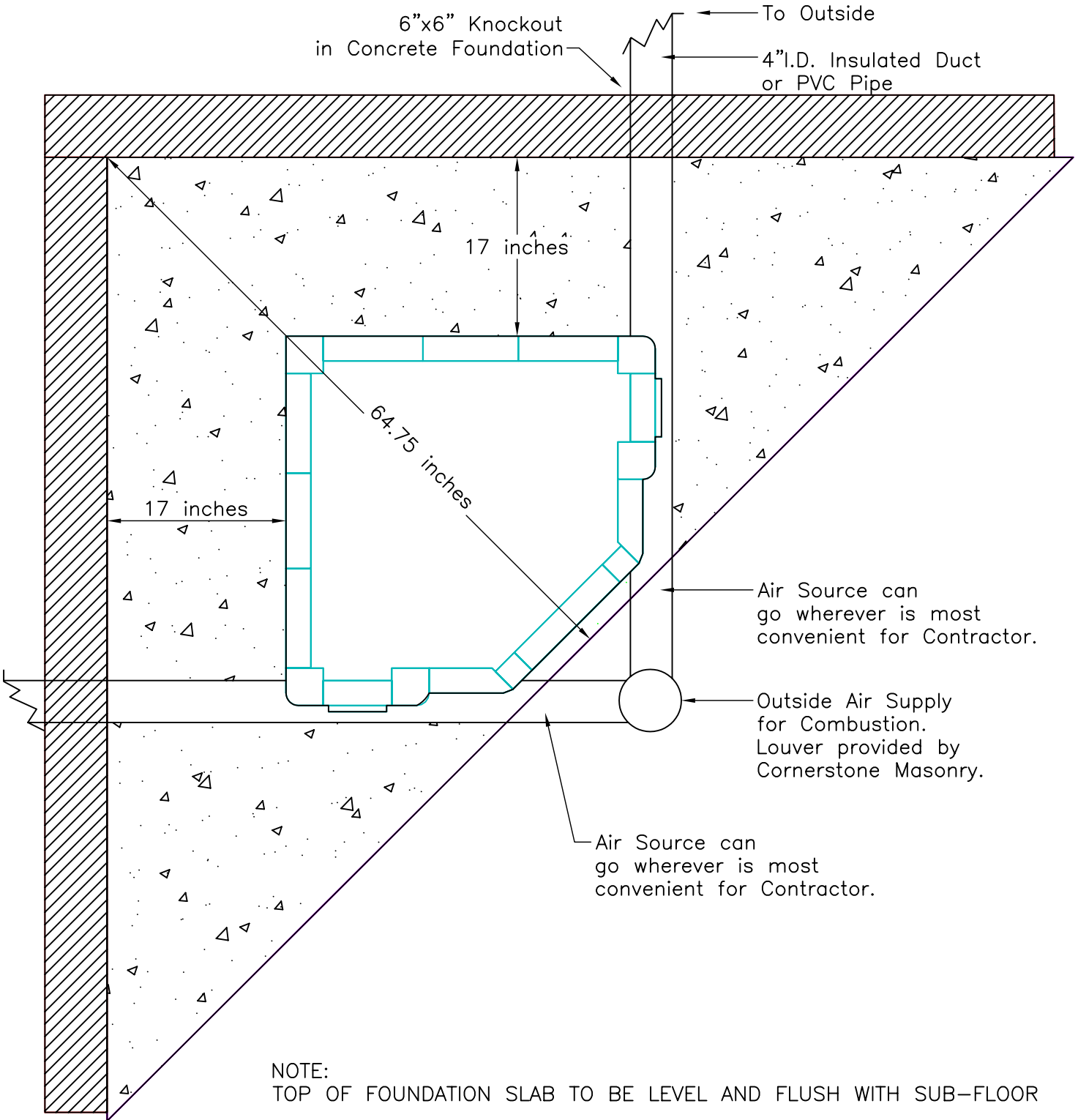

INFORMATION ONLY

UNIT WEIGHT: Approx 5500lbs.

Contractor is responsible for engineering foundation slab to support weight of fireplace.



CORNERSTONE MASONRY
P.O. Box 83
Pray, MT 59065
(800)321-7010 Fax 406-333-4383

PROJECT GRIFFIT
MODEL KTLU2030/1

CONTRACT
DRAWN BY D.P.BYRAM

VIEW SUPPORT
DATE 5/19/04

PAGE 5