

# INFORMATION ONLY

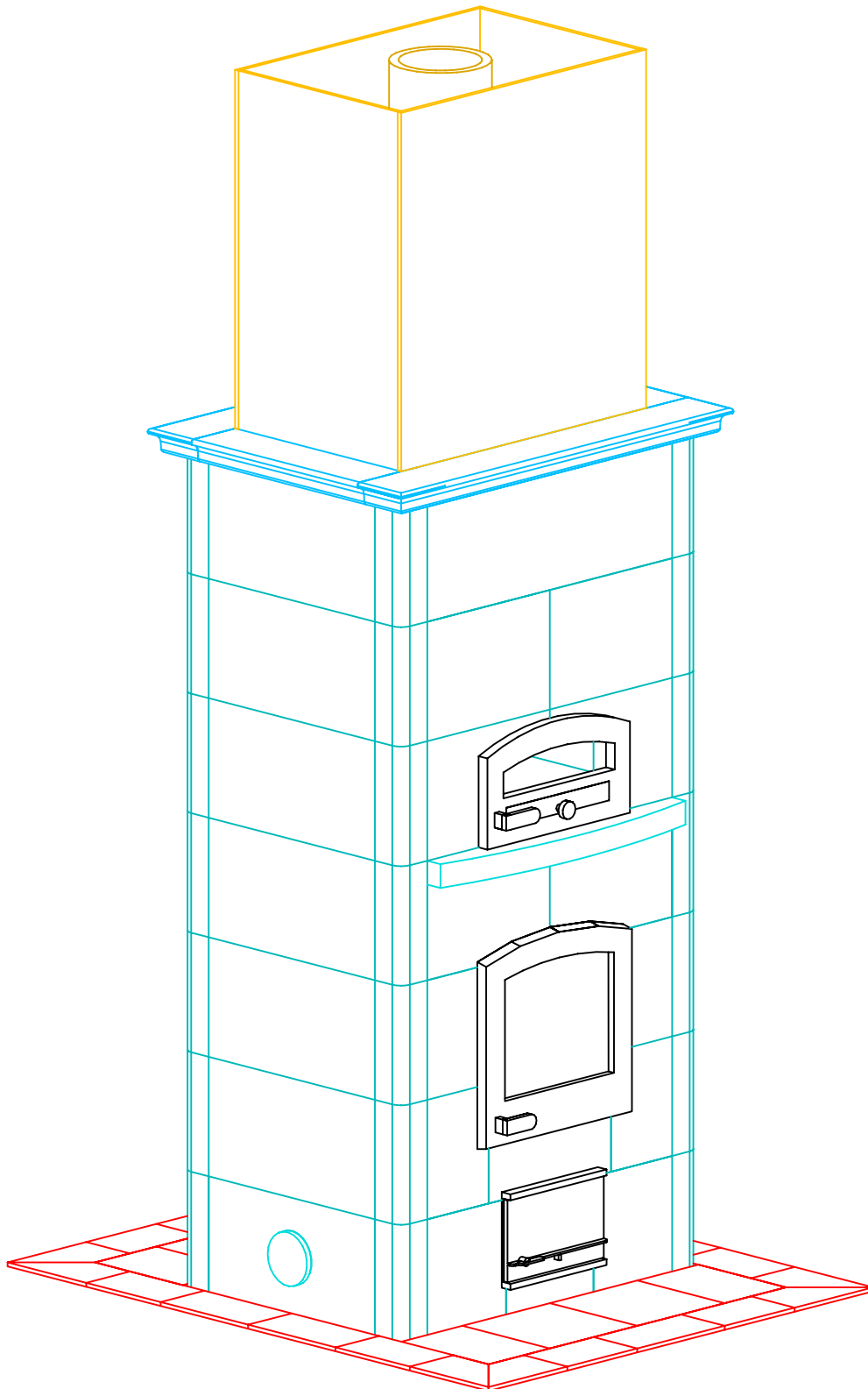

NOTE: HEARTH TILES INSTALLED BY OTHERS



MID-ATLANTIC MASONRY HEAT  
 McIntire Business Park  
 Charlottesville, VA 22903  
 (434)979-9709 Fax 434-979-6416

PROJECT  
 McDaniel  
 MODEL  
 TTU2700/5

CONTRACT  
 DRAWN BY  
 D.POWLEY

VIEW  
 ISOMETRIC  
 DATE  
 4/26/02

PAGE  
 1

# INFORMATION ONLY

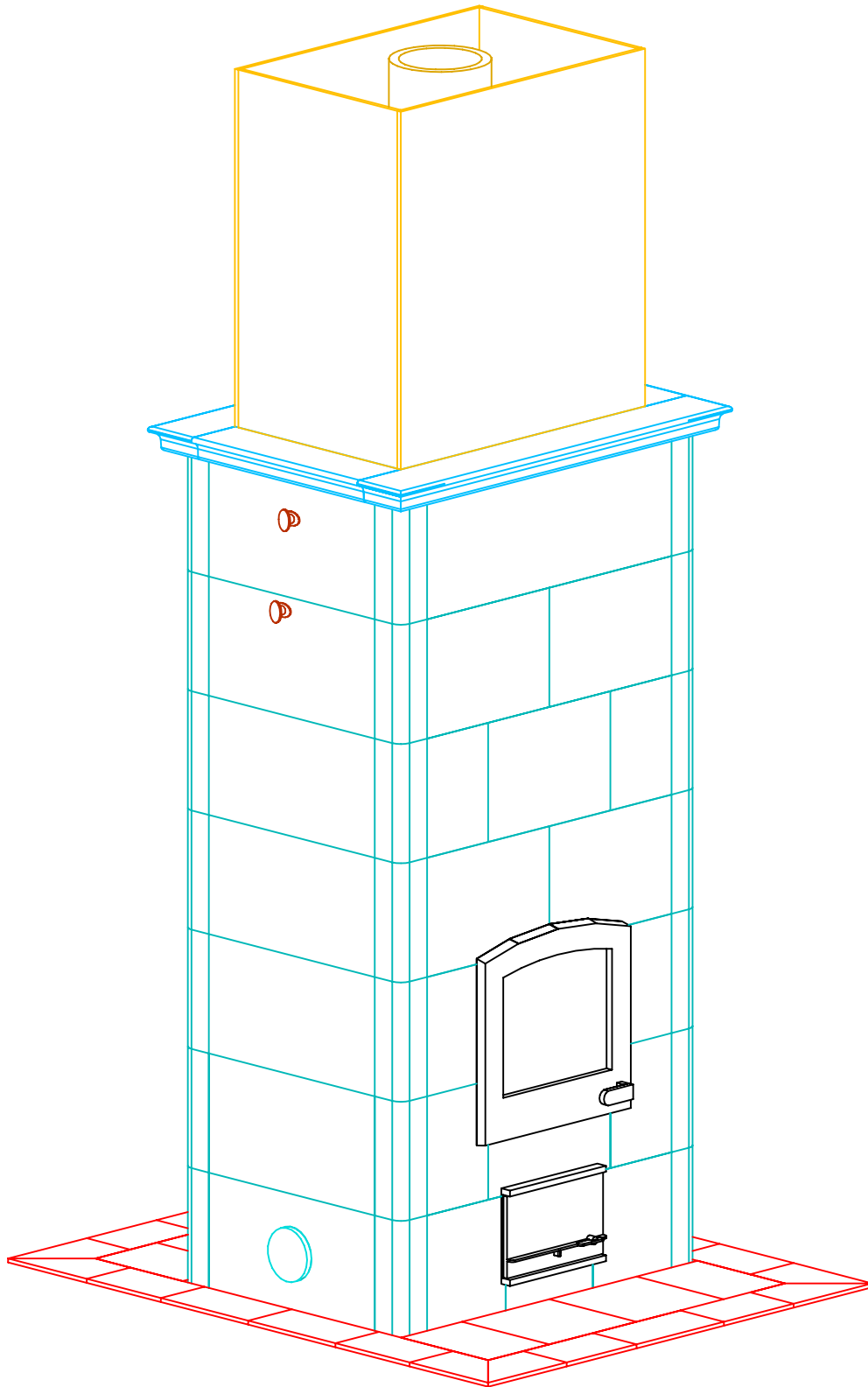

NOTE: HEARTH TILES INSTALLED BY OTHERS



MID-ATLANTIC MASONRY HEAT  
McIntire Business Park  
Charlottesville, VA 22903  
(434)979-9709 Fax 434-979-6416

PROJECT  
McDaniel  
MODEL  
TTU2700/5

CONTRACT  
DRAWN BY  
D.POWLEY

VIEW  
ISOMETRIC  
DATE  
4/26/02

PAGE  
2

# INFORMATION ONLY

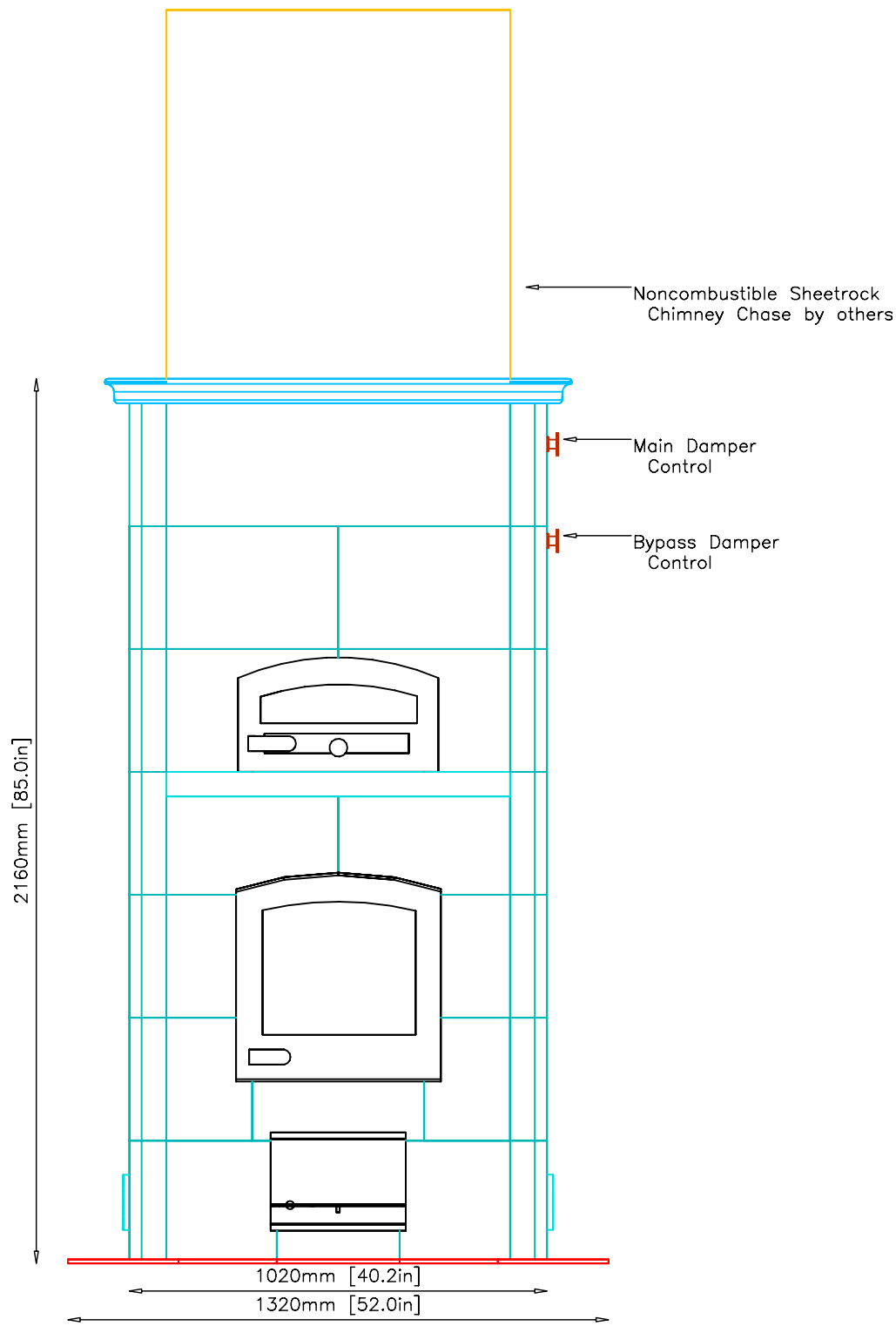

# INFORMATION ONLY

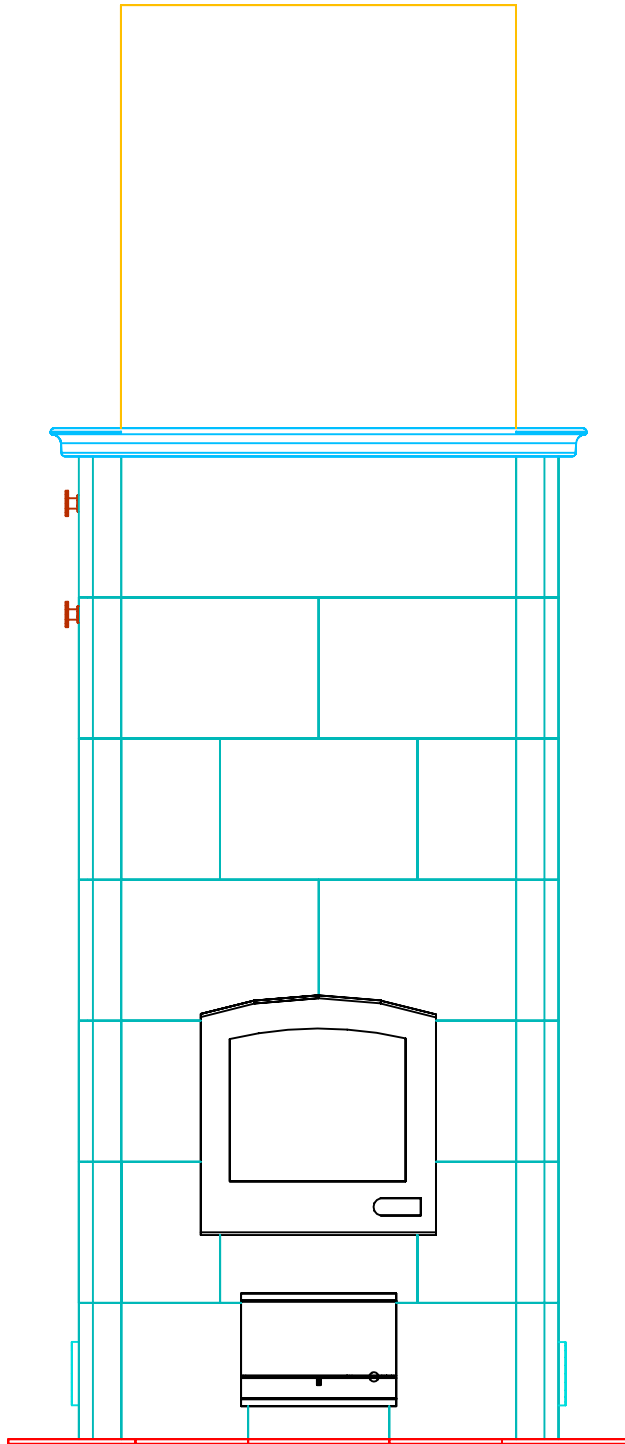

# INFORMATION ONLY

Noncombustible Sheetrock Chimney Chase by others →

Main Damper Control

Bypass Damper Control

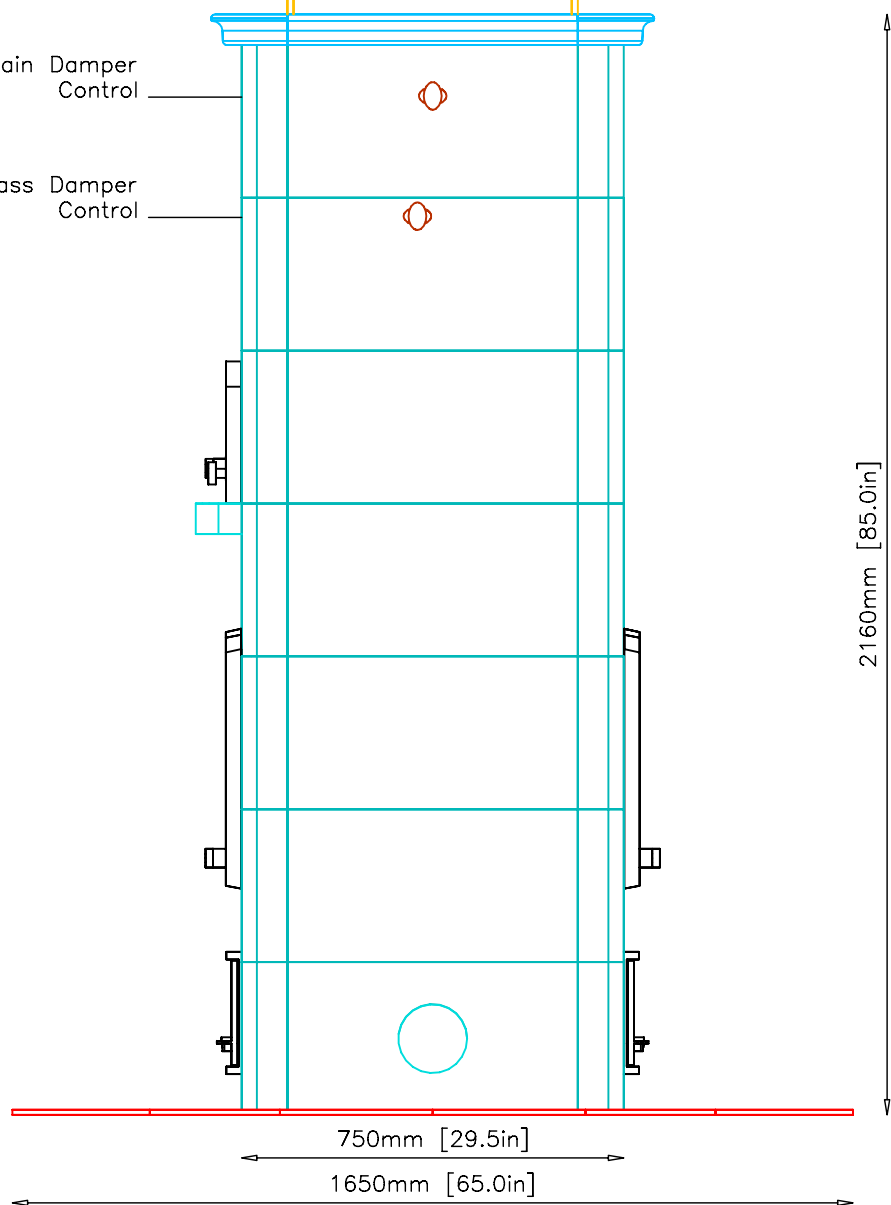

**INFORMATION ONLY**

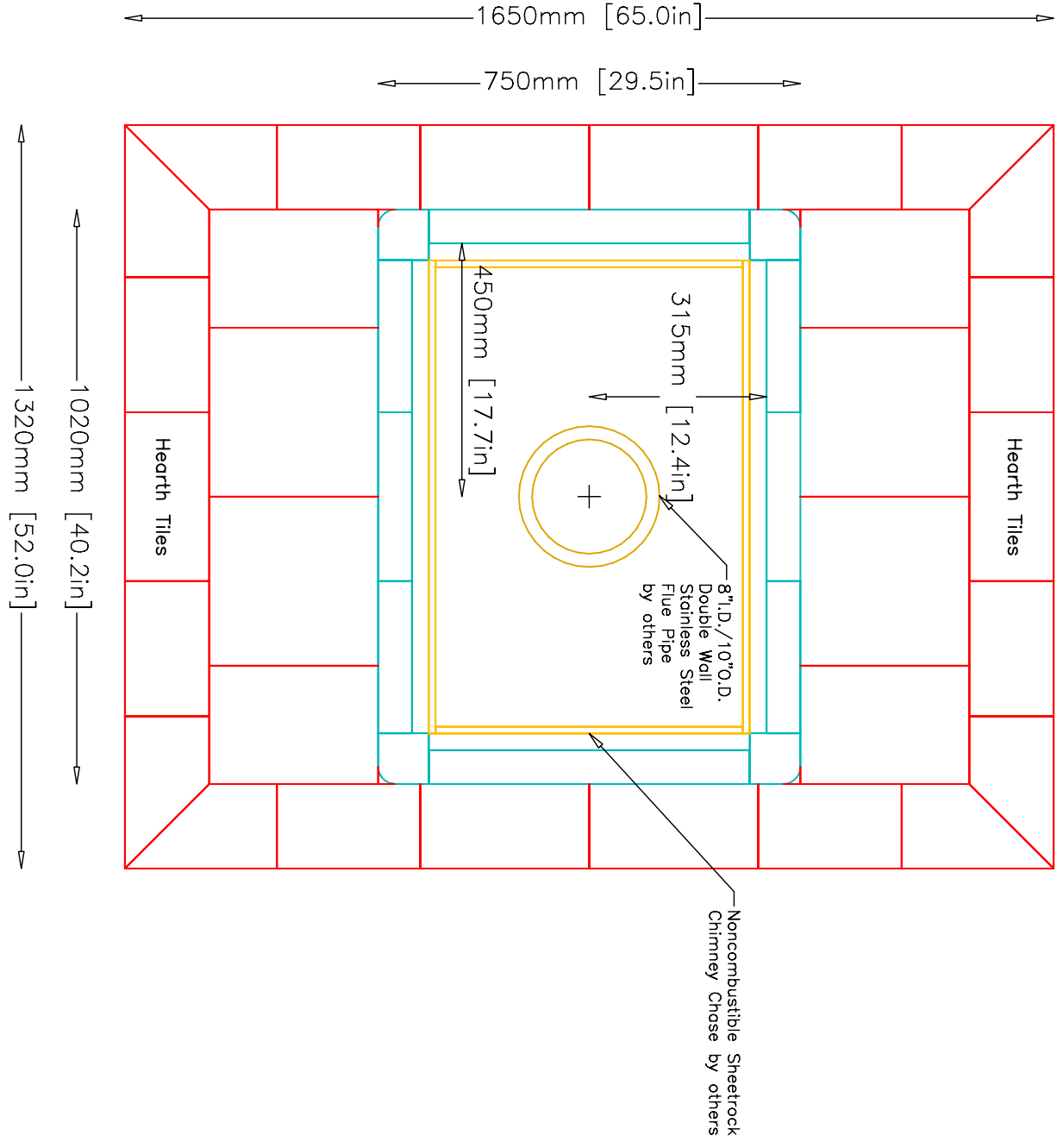

NOTE: HEARTH TILES INSTALLED BY OTHERS

# CAPPING SLAB

**INFORMATION ONLY**

Recommended Dimensions:  
Entire Hearth Area— 52" x 65"

Minimum Dimensions:  
2" from Base of Unit— 33.5" x 44"

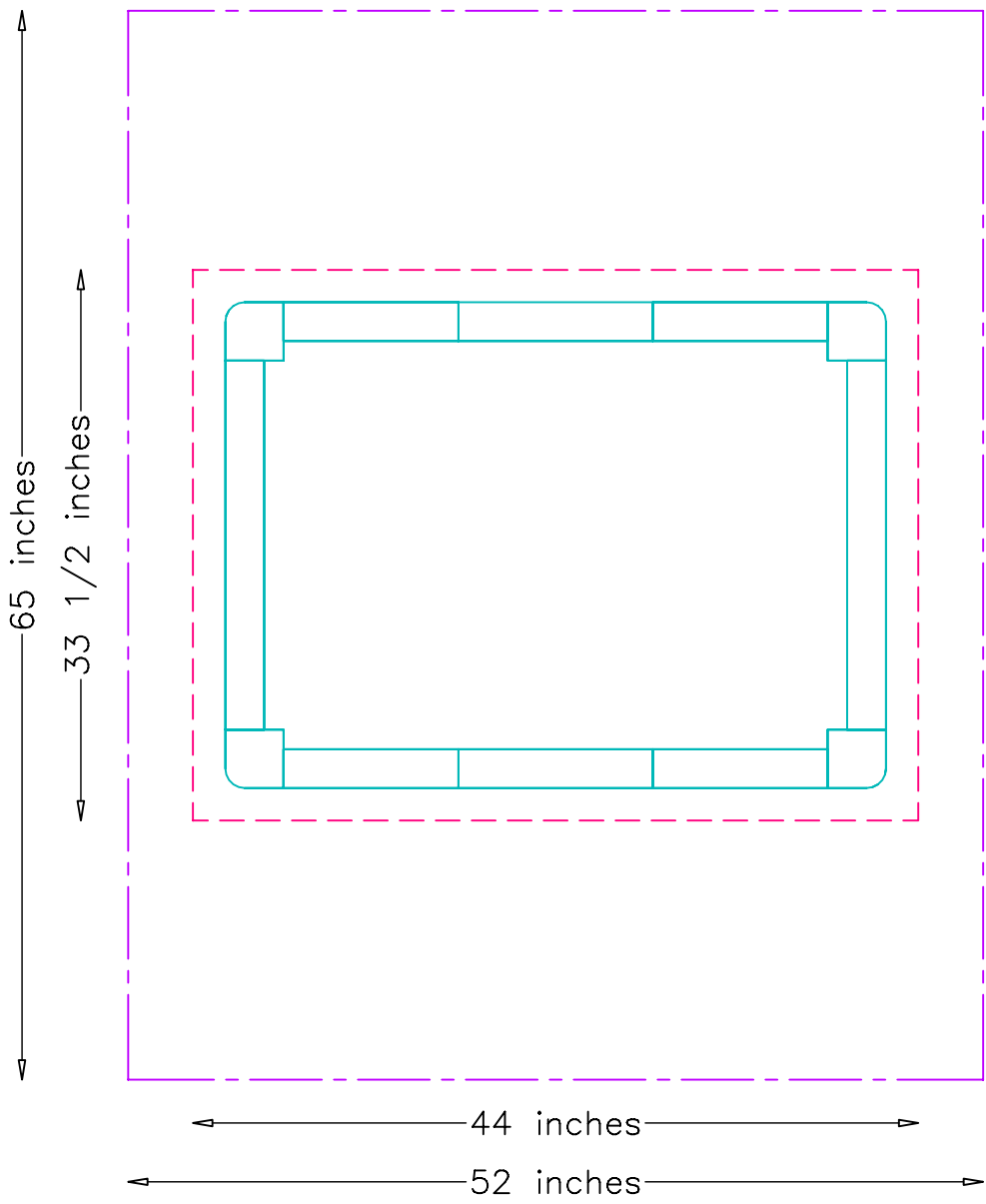

NOTE:  
TOP OF CAPPING SLAB TO BE LEVEL AND FLUSH WITH SUB-FLOOR  
Tolerances: +/- 1/8" No addition cost to adjust slab  
+/- 1/4" \$150.00-\$200.00 additional cost to adjust slab  
+/- 1/2" \$500.00 additional cost to adjust slab

UNIT WEIGHT: Approx. 7000lbs.  
Contractor is responsible for engineering capping slab to support weight of fireplace.

	MID-ATLANTIC MASONRY HEAT McIntire Business Park Charlottesville, VA 22903 (434)979-9709 Fax 434-979-6416	PROJECT	CONTRACT	VIEW	PAGE
		McDaniel MODEL TTU2700/5	DRAWN BY D.POWLEY	SUPPORT DATE 4/26/02	