

Heat Shield Pedestal
3/4in. Steel Plate by others
See page 5 for Details

INFORMATION ONLY

NOTE: Hearth Tiles CUT AND INSTALLED by others



MID-ATLANTIC MASONRY HEAT
1229 Harris Street Suite 1
Charlottesville, VA 22903
(434)979-9709 Fax 434-979-6416

PROJECT LAND
MODEL TU2500/L

CONTRACT 5631
DRAWN BY T.A. LA BIER

VIEW PERSPECTIVE
DATE 03/05/04

PAGE 1

FRONT VIEW

INFORMATION ONLY

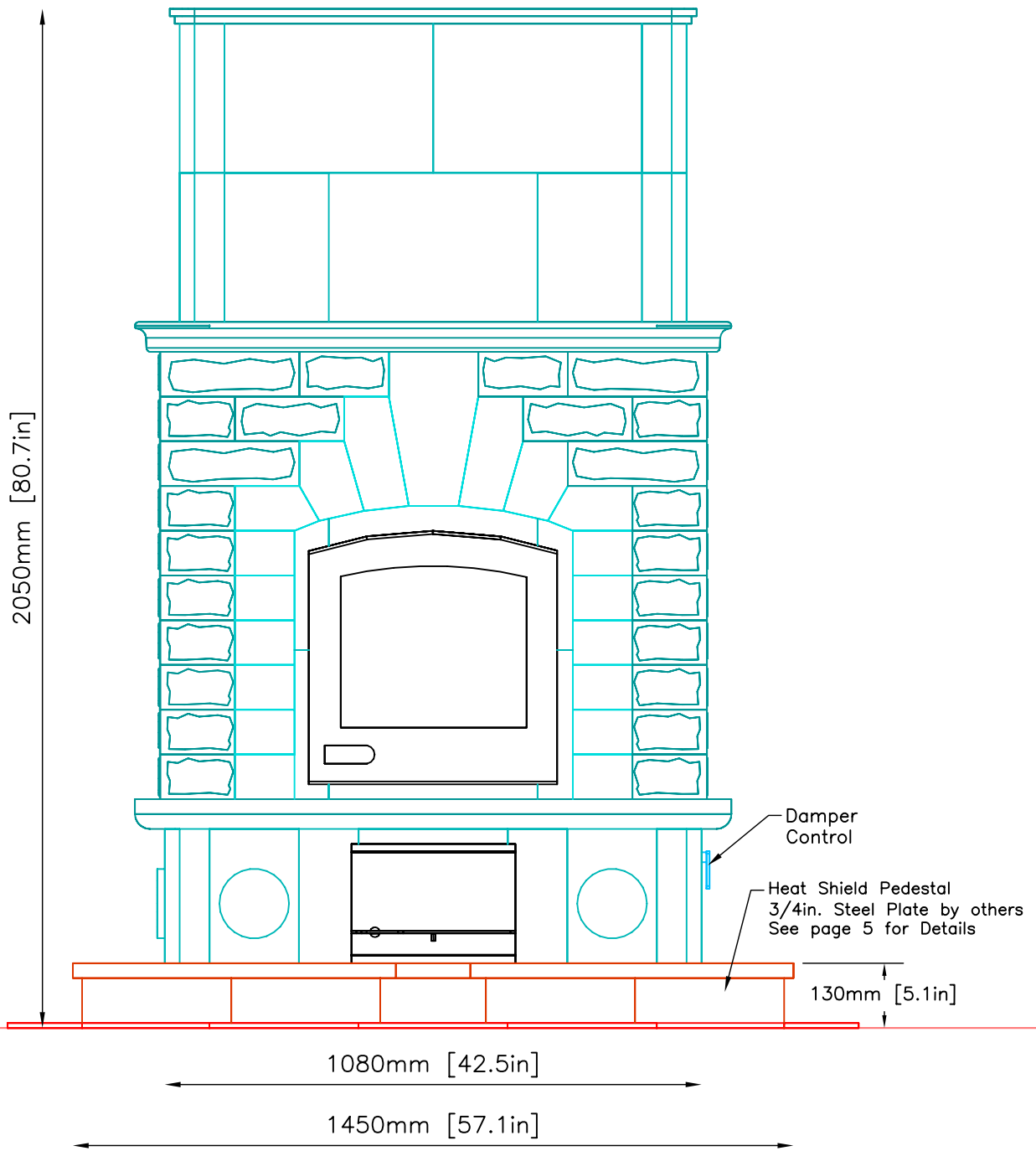

NOTE: Hearth Tiles CUT AND INSTALLED by others



MID-ATLANTIC MASONRY HEAT
1229 Harris Street Suite 1
Charlottesville, VA 22903
(434)979-9709 Fax 434-979-6416

PROJECT LAND
MODEL TU2500/L

CONTRACT 5631
DRAWN BY T.A. LA BIER

VIEW FRONT
DATE 03/05/04

PAGE 2

SIDE VIEW

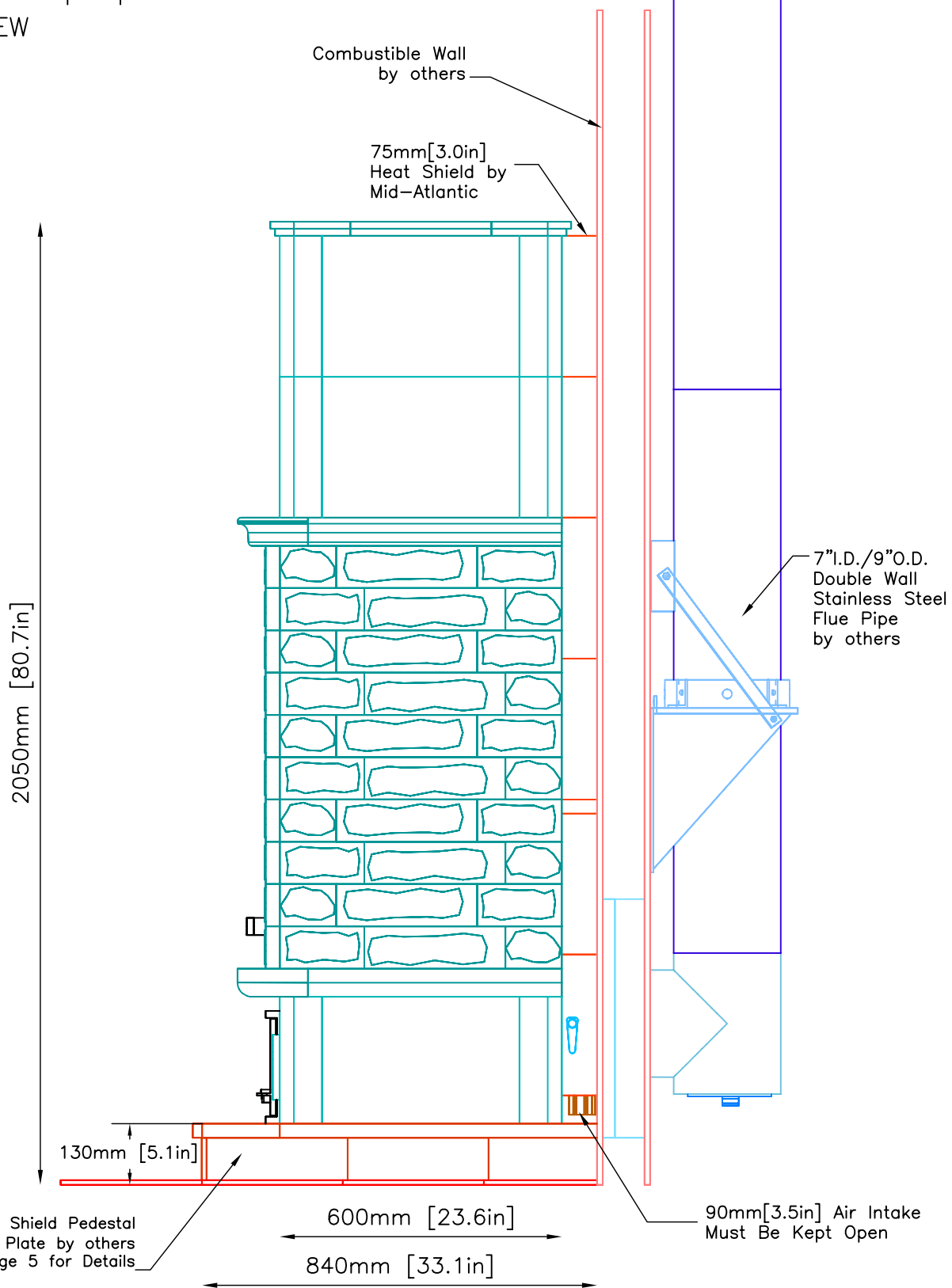

INFORMATION ONLY

NOTE: Hearth Tiles CUT AND INSTALLED by others

PLAN VIEW

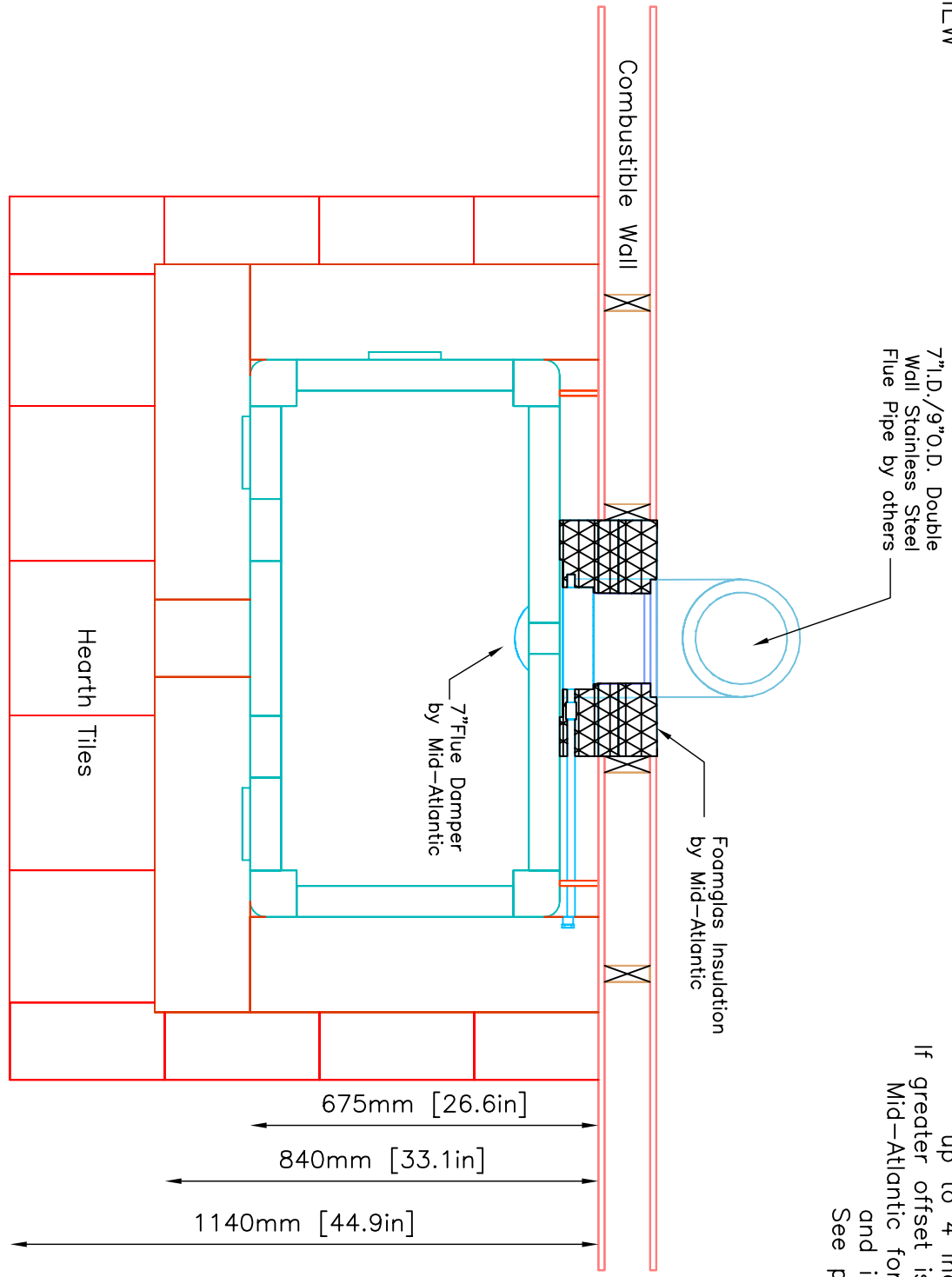

Flue Location may be offset up to 4 inches right or left. If greater offset is needed, contact Mid-Atlantic for revised drawings and installation pricing. See page 6 for Details

NOTE: Hearth Tiles CUT AND INSTALLED by others

INFORMATION ONLY

	MID-ATLANTIC MASONRY HEAT 1229 Harris Street Suite 1 Charlottesville, VA 22903 (434)979-9709 Fax 434-979-6416	PROJECT	CONTRACT	VIEW	PAGE
		LAND	5631	PLAN	4
		MODEL	DRAWN BY	DATE	
		TU2500/L	T.A.LA BIER	03/05/04	

INFORMATION ONLY

STEEL PLATE PEDESTAL 3/4" STEEL PLATE-BY OTHERS

NOTE:
STEEL PLATE TO BE LEVEL
Tolerances:
+/- 1/8" No additional cost to adjust steel plate
+/- 1/4" \$150.00-\$200.00 additional cost to adjust steel plate
+/- 1/2" \$500.00 additional cost to adjust steel plate

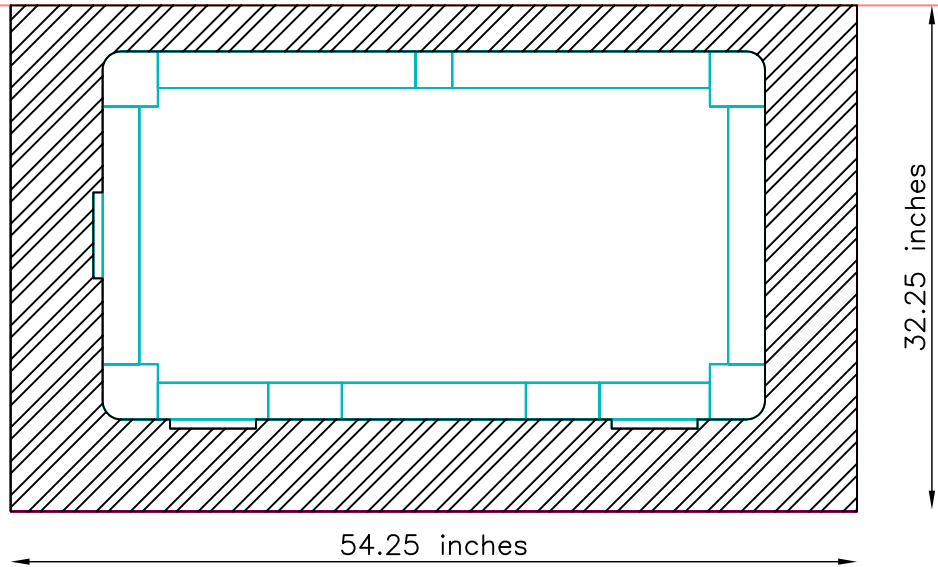

UNIT WEIGHT: 5500lbs.

Owner/Contractor is responsible for engineering steel plate to support weight of fireplace, as specified above, without deflection.

Note: Bottom of 3/4" Steel Plate can rest on sub-floor but MUST be Level.

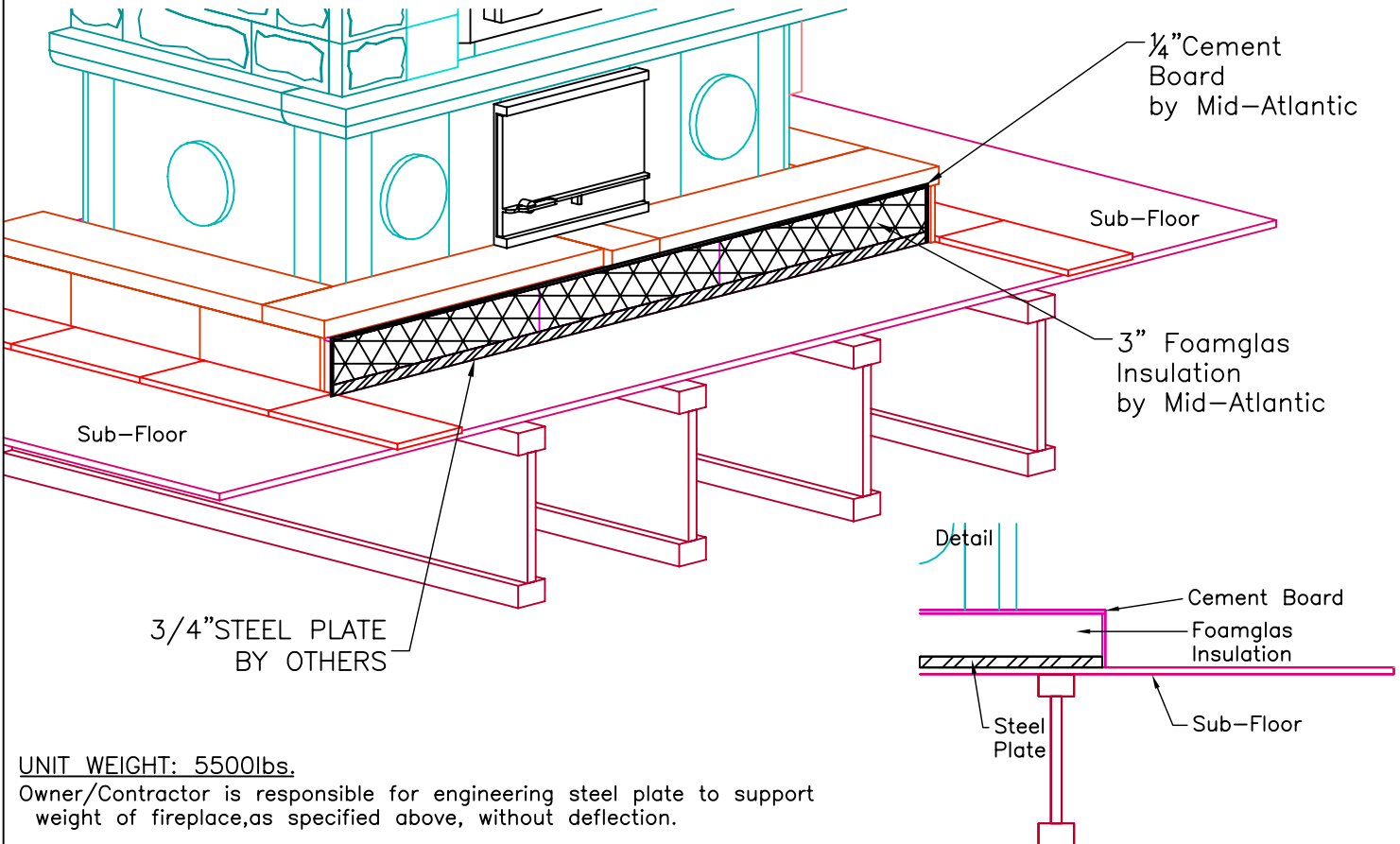

UNIT WEIGHT: 5500lbs.

Owner/Contractor is responsible for engineering steel plate to support weight of fireplace, as specified above, without deflection.