

# INFORMATION ONLY

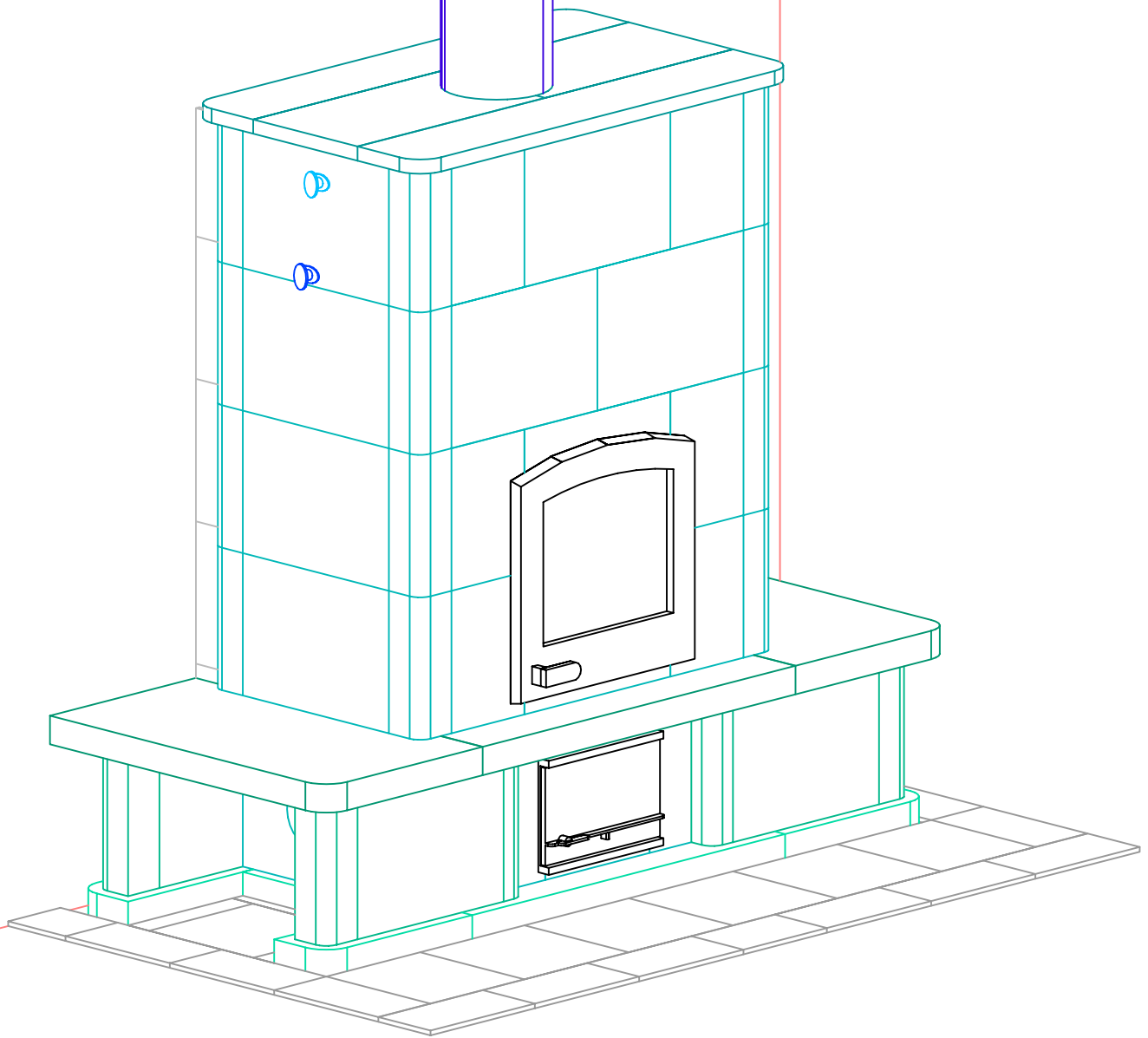

NOTE: Hearth Tiles CUT AND INSTALLED by others



MID-ATLANTIC MASONRY HEAT  
 1229 Harris Street Suite 1  
 Charlottesville, VA 22903  
 (434)979-9709 Fax 434-979-6416

PROJECT  
 OUTLAW  
 MODEL  
 TU2200

CONTRACT  
 DRAWN BY  
 D.P.BYRAM

VIEW  
 PERSPECTIVE  
 DATE  
 9/4/03

PAGE  
 1

FRONT VIEW

**INFORMATION ONLY**

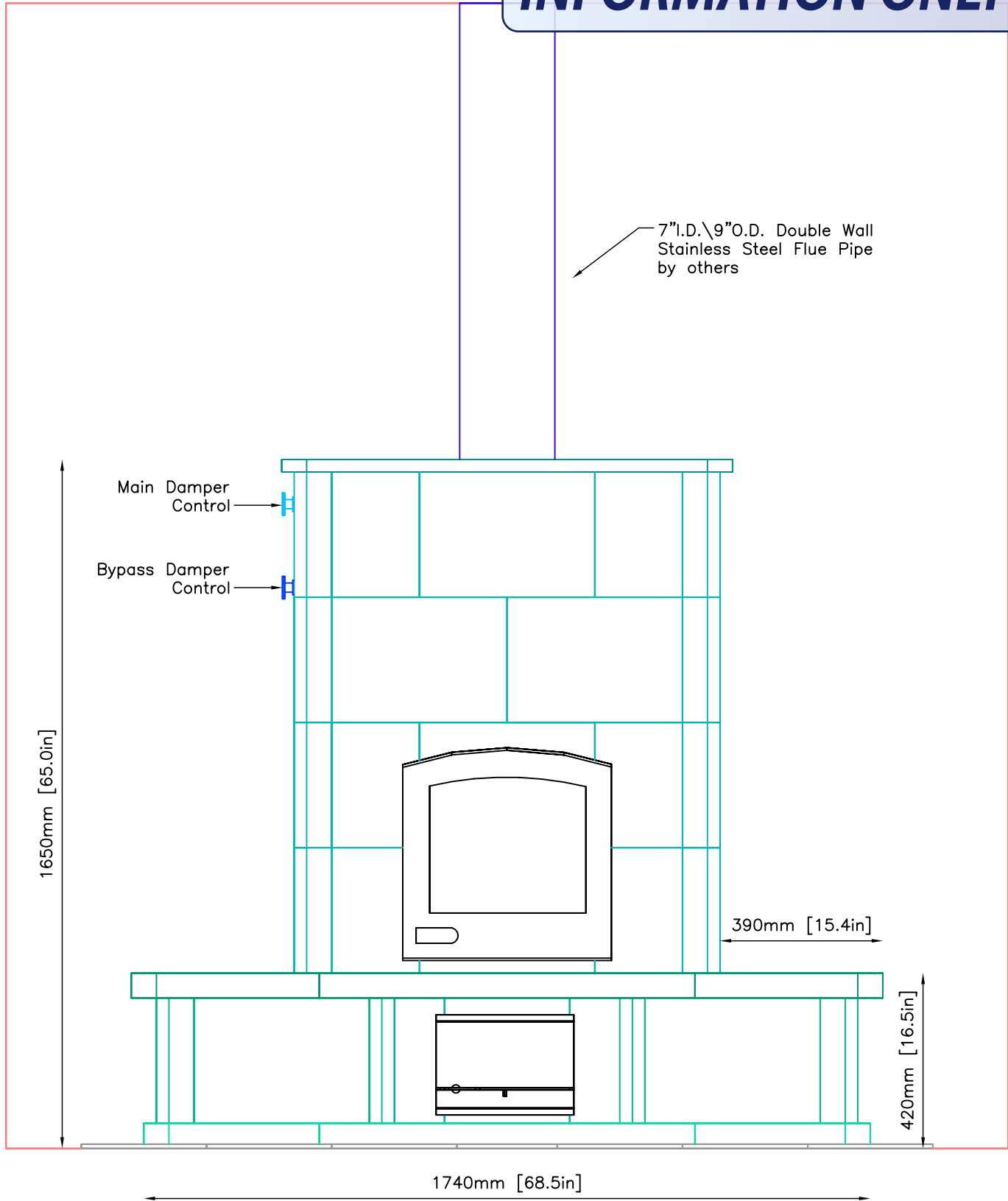

SIDE VIEW

**INFORMATION ONLY**

7" I.D. \ 9" O.D. Double Wall  
Stainless Steel Flue Pipe  
by others

4.5" Combustible Wall  
by others

75mm [3.0in] Heat Shield  
by Mid-Atlantic

1650mm [65.0in]

690mm [27.2in]

90mm Air Intake  
MUST be Kept Open

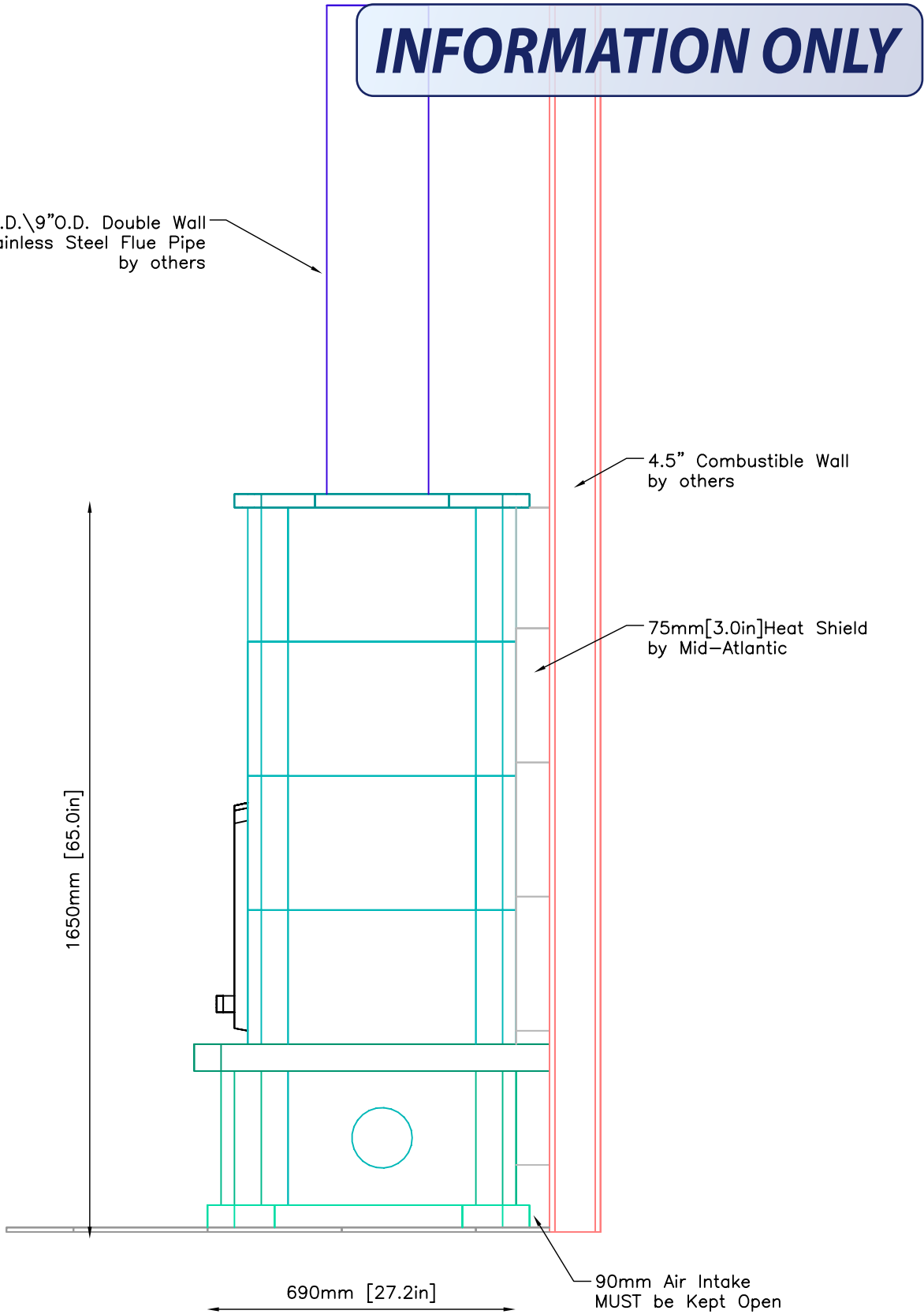

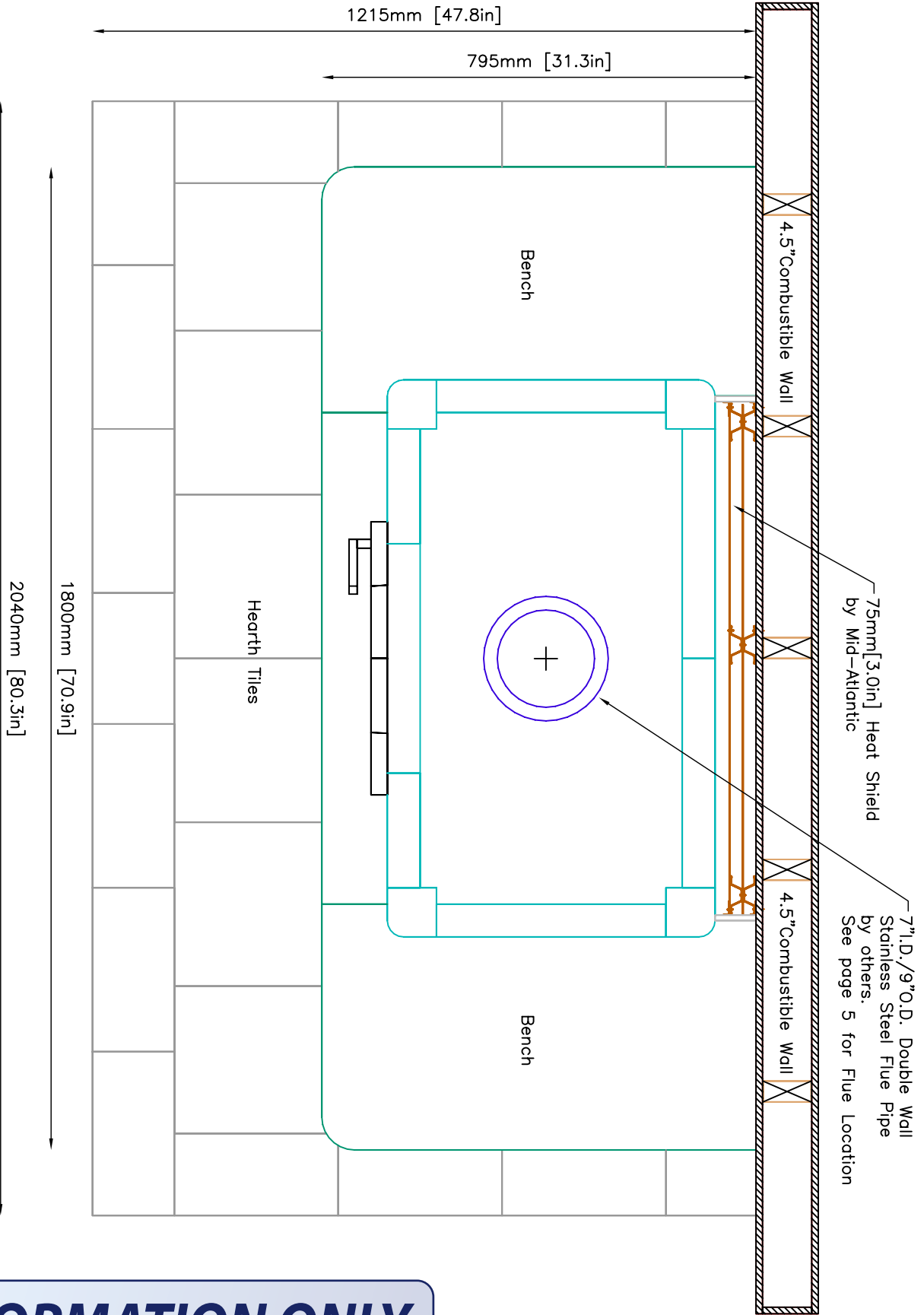

NOTE: Hearth Tiles CUT AND INSTALLED by others

**INFORMATION ONLY**

	MID-ATLANTIC MASONRY HEAT 1229 Harris Street Suite 1 Charlottesville, VA 22903 (434)979-9709 Fax 434-979-6416	PROJECT	CONTRACT	VIEW	PAGE
		OUTLAW		PLAN	4
		MODEL	DRAWN BY	DATE	
		TU2200	D.P.BYRAM	9/4/03	

# FOUNDATION SLAB

Minimum 4" Thick Poured Concrete With Rebar 6"O.C.  
 Minimum Dimensions--2" from Base of Unit

Flue Location 17" x 36 1/4" From LOWER Right Corner of Foundation Slab To CENTER of Flue Pipe

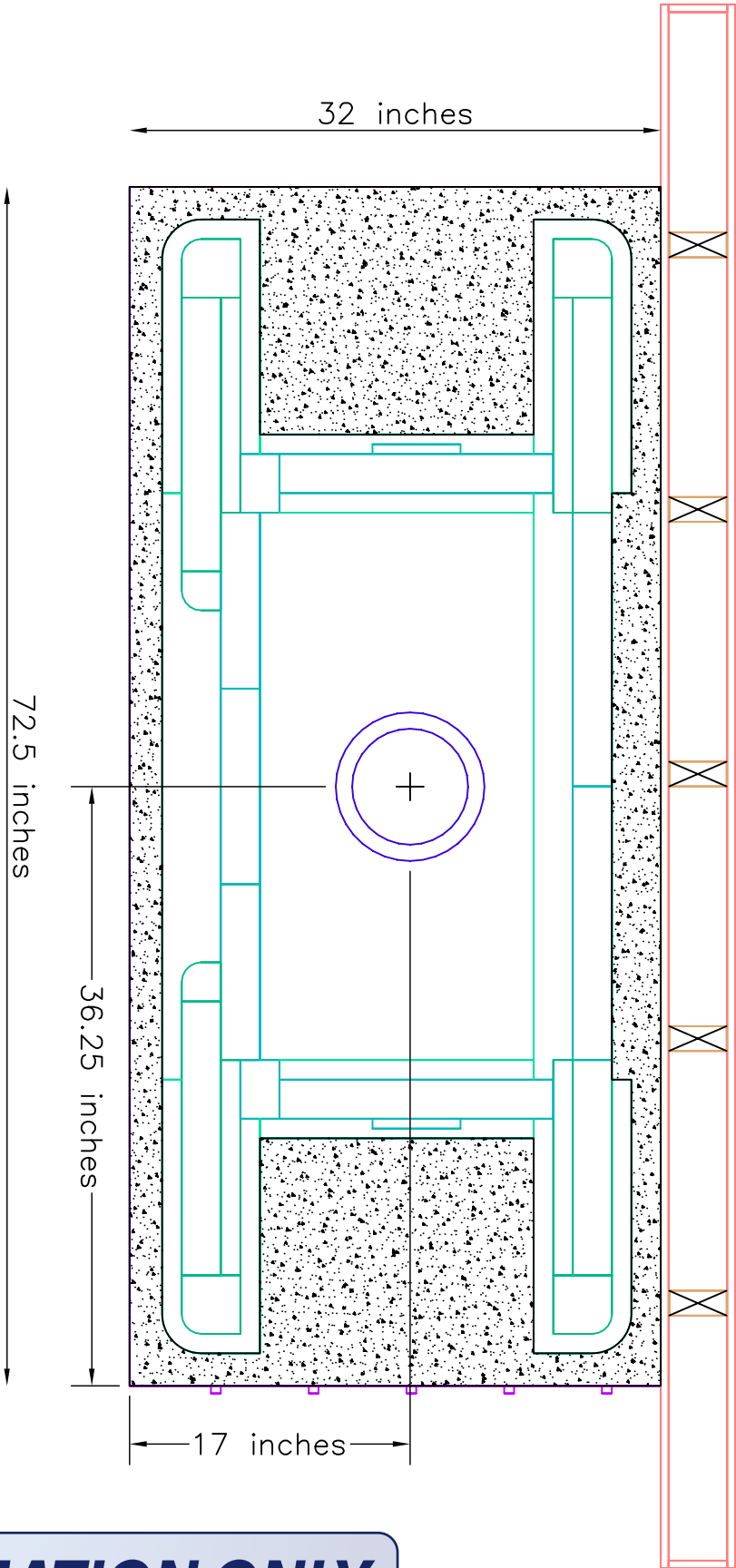

**NOTE:**  
 TOP OF FOUNDATION SLAB TO BE LEVEL AND FLUSH WITH SUB-FLOOR  
 Tolerances: +/- 1/8" No additional cost to adjust slab  
 +/- 1/4" \$150.00--\$200.00 additional cost to adjust slab  
 +/- 1/2" \$500.00 additional cost to adjust slab

**UNIT WEIGHT: MINIMUM 3500lbs.**  
 Contractor is responsible for engineering foundation slab to support weight of fireplace.

## INFORMATION ONLY



MID-ATLANTIC MASONRY HEAT  
 1229 Harris Street Suite 1  
 Charlottesville, VA 22903  
 (434)979-9709 Fax 434-979-6416

PROJECT  
 OUTLAW  
 MODEL  
 TU2200

CONTRACT  
 DRAWN BY  
 D.P.BYRAM

VIEW  
 SUPPORT  
 DATE  
 9/4/03

PAGE

5

**FOUNDATION SLAB:**

- \* MINIMUM 4" THICK WITH REBAR 6" O.C.
- \* NONCOMBUSTIBLE CEMENT BOARD under foundation slab (NOT PLYWOOD)

**INFORMATION ONLY**

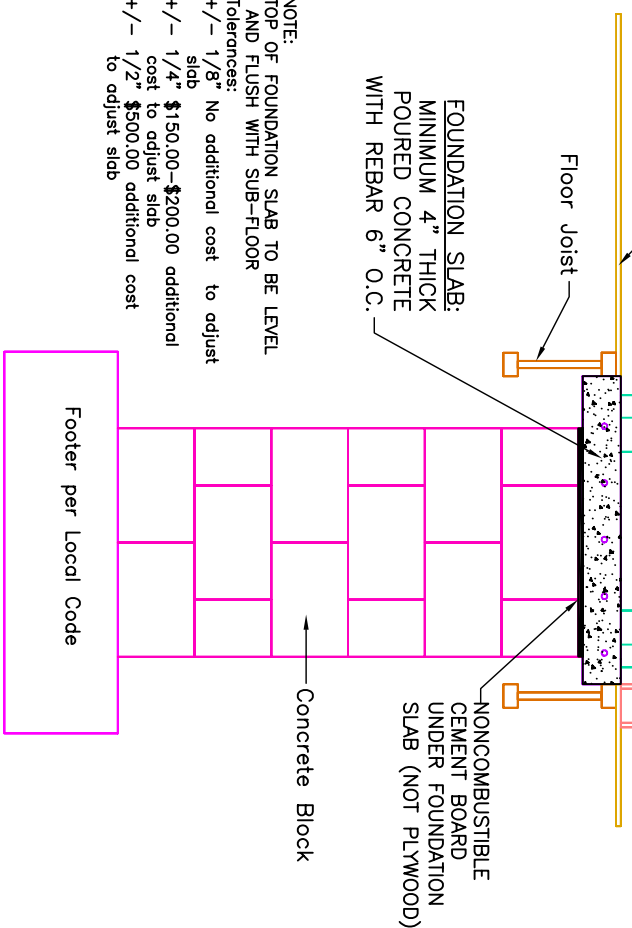

**NOTE:**  
 TOP OF FOUNDATION SLAB TO BE LEVEL AND FLUSH WITH SUB-FLOOR  
 Tolerances:  
 +/- 1/8" No additional cost to adjust slab  
 +/- 1/4" \$150.00-\$200.00 additional cost to adjust slab  
 +/- 1/2" \$500.00 additional cost to adjust slab

**UNIT WEIGHT: MINIMUM 3500lbs.**  
 Contractor is responsible for engineering foundation slab to support weight of fireplace.

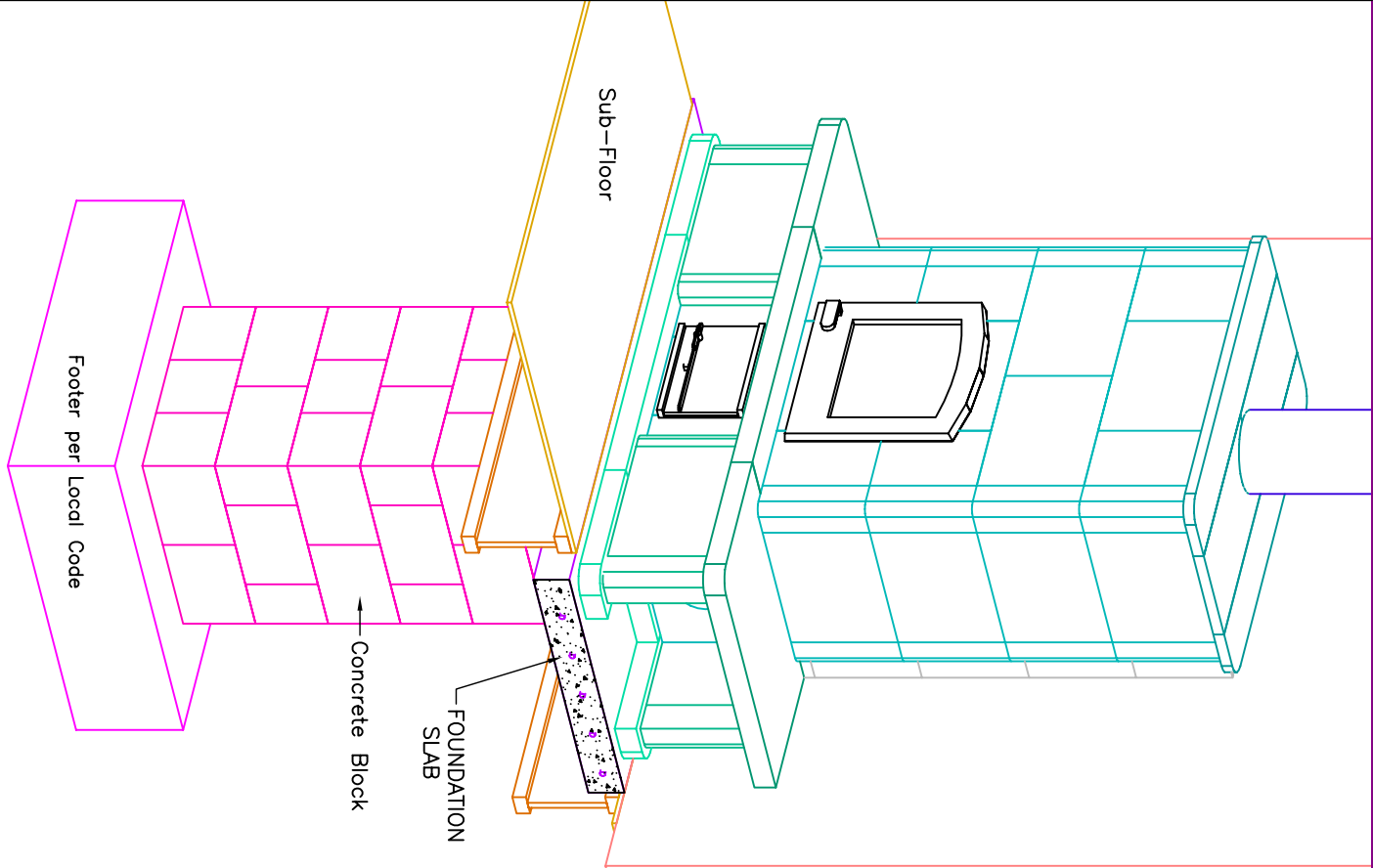

MID-ATLANTIC MASONRY HEAT  
 McIntire Business Park  
 Charlottesville, VA 22903  
 (434)979-9709 Fax 434-979-6416

PROJECT  
 OUTLAW  
 MODEL  
 TU2200

CONTRACT  
 DRAWN BY  
 D.P.BYRAM

VIEW  
 Foundation Slab  
 DATE  
 9/4/03

PAGE  
 6