

INFORMATION ONLY

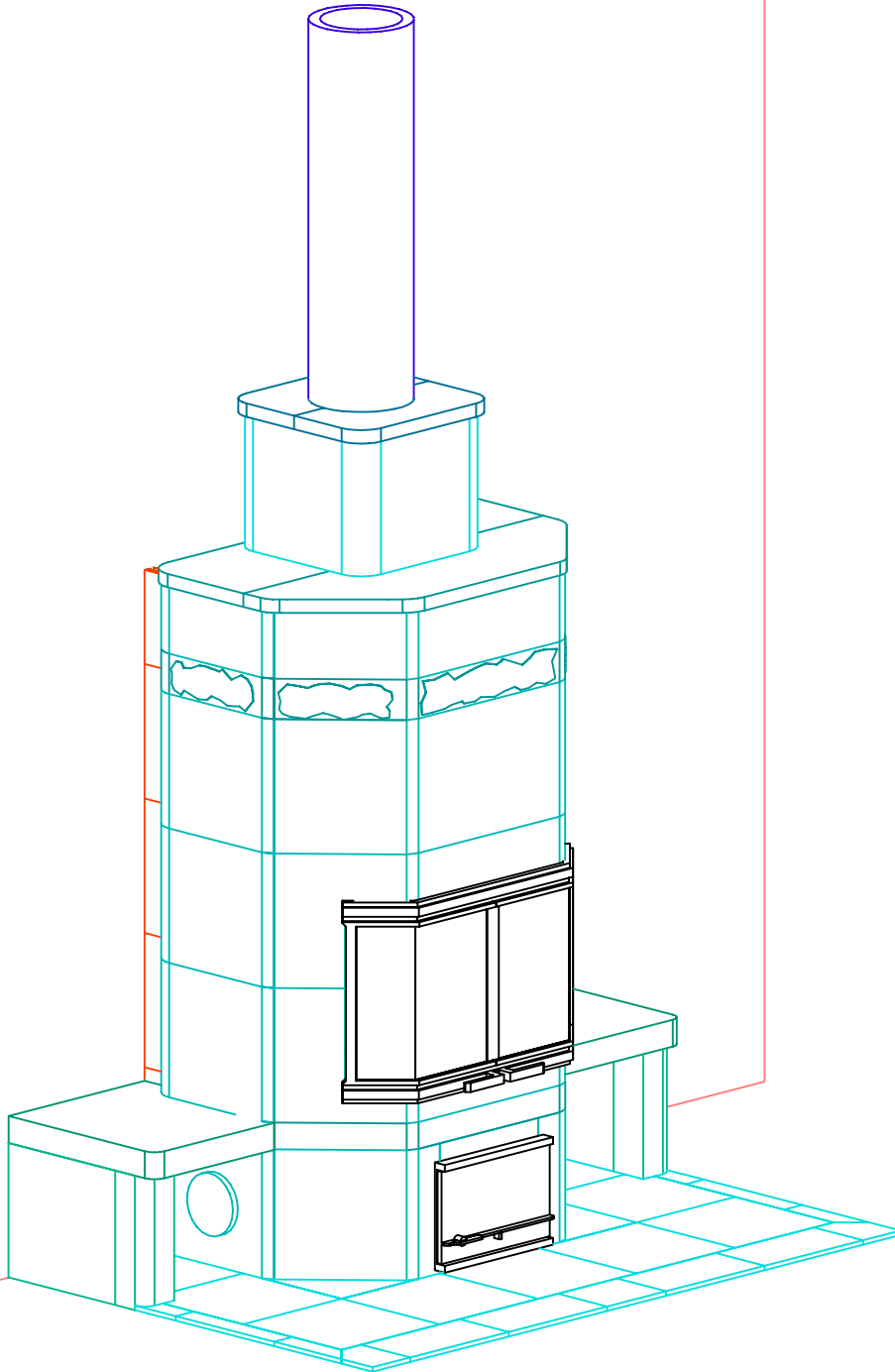

REQUIRED:

Tulikivi's UL Listing requires minimum non-combustible hearth extension of 16" in front of the firebox door and 8" beyond either side of the firebox door.

Shown: Tulikivi Soapstone Tile. CUT AND INSTALLED by others



FIREPLACE EDITIONS
1035 Mt. Carmel Church Road
Chapel Hill, NC 27517
(919)968-8101 Fax 919-969-8353

PROJECT LONDON
MODEL TU1230

CONTRACT
DRAWN BY J.CHAMPION

VIEW PERSPECTIVE
DATE 8/22/05

PAGE 1

INFORMATION ONLY

FRONT VIEW

No Combustible Materials Within
14" of Sides of Fireplace

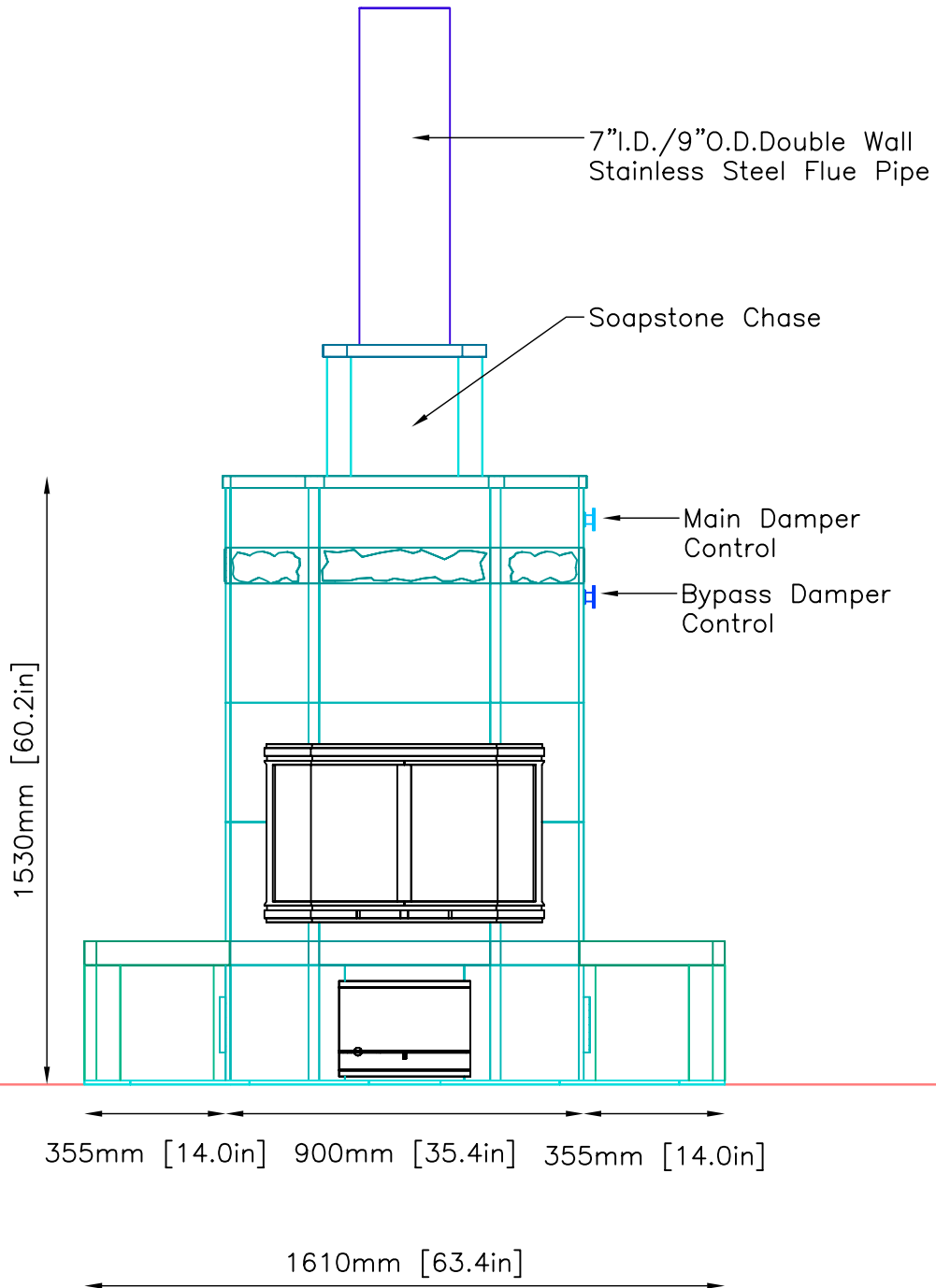

REQUIRED:

Tulikivi's UL Listing requires minimum non-combustible hearth extension of 16" in front of the firebox door and 8" beyond either side of the firebox door.

Shown: Tulikivi Soapstone Tile. CUT AND INSTALLED by others



FIREPLACE EDITIONS
1035 Mt. Carmel Church Road
Chapel Hill, NC 27517
(919)968-8101 Fax 919-969-8353

PROJECT LONDON
MODEL TU1230

CONTRACT
DRAWN BY J.CHAMPION

VIEW FRONT
DATE 8/22/05

PAGE

2

INFORMATION ONLY

SIDE VIEW

No Combustible Materials Within 14" of Sides of Fireplace

7" I.D./9" O.D. Double Wall Stainless Steel Flue Pipe

Soapstone Chase

Main Damper Control

Bypass Damper Control

Combustible Wall by others

75mm [3.0in] Heat Shield by Mid-Atlantic. UL Listing requires top of heat shield to remain open for proper air flow.

NOTE: UL Listing requires MINIMUM 2in high x 3in wide Air Intake opening between floor and metal heat shield. This MUST be kept open.

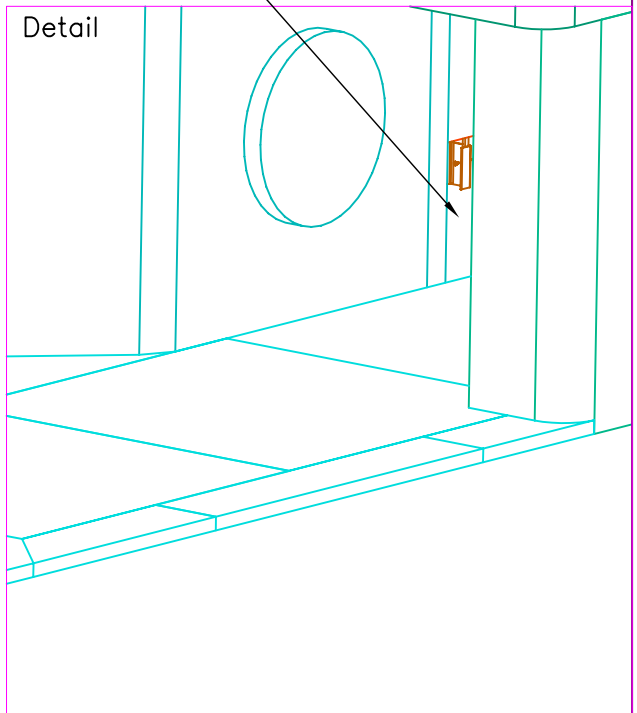
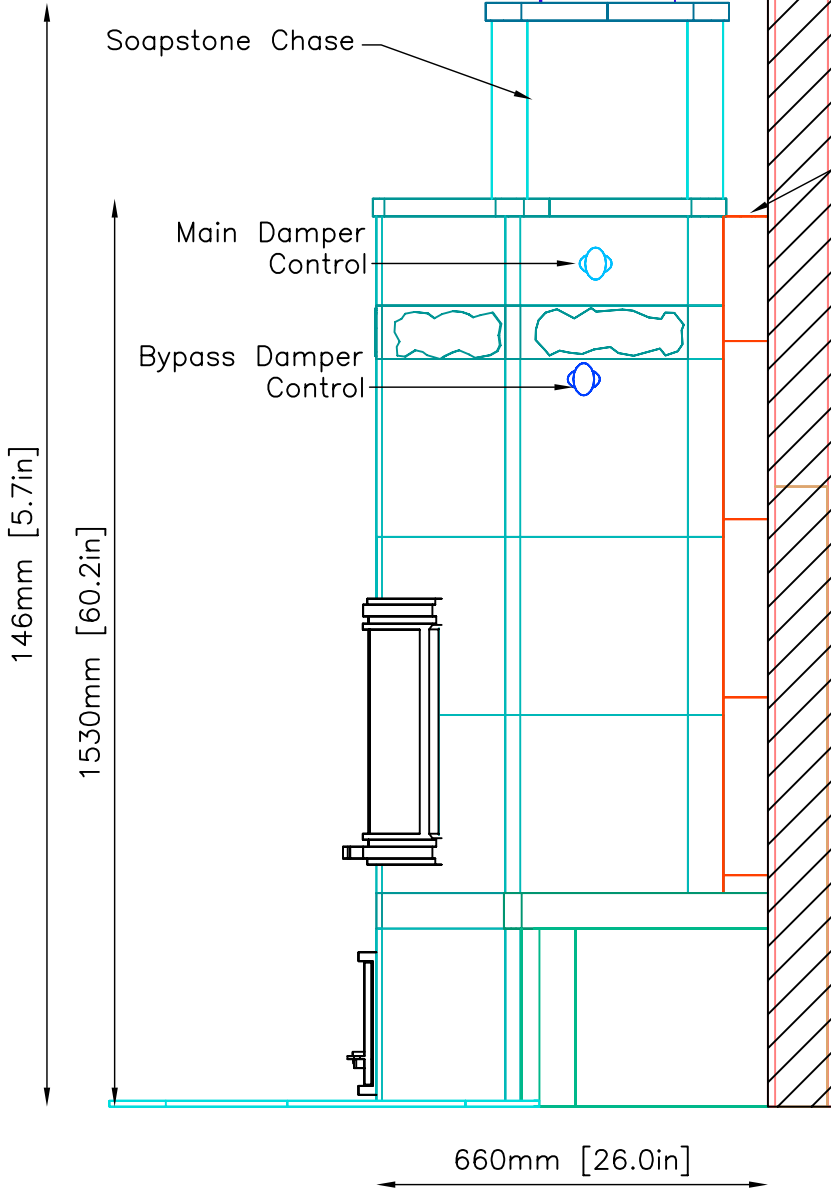

REQUIRED:

Tulikivi's UL Listing requires minimum non-combustible hearth extension of 16" in front of the firebox door and 8" beyond either side of the firebox door. Shown: Tulikivi Soapstone Tile. CUT AND INSTALLED by others

PLAN VIEW

No Combustible Materials Within
14" of Sides of Fireplace

7",D./9"O.D. Double
Wall Stainless Steel
Flue Pipe
SEE PAGE 5 FOR
FLUE LOCATION

75mm[3.0in]Heat Shield
UL Listing requires top
of heat shield to remain
open for proper air flow.

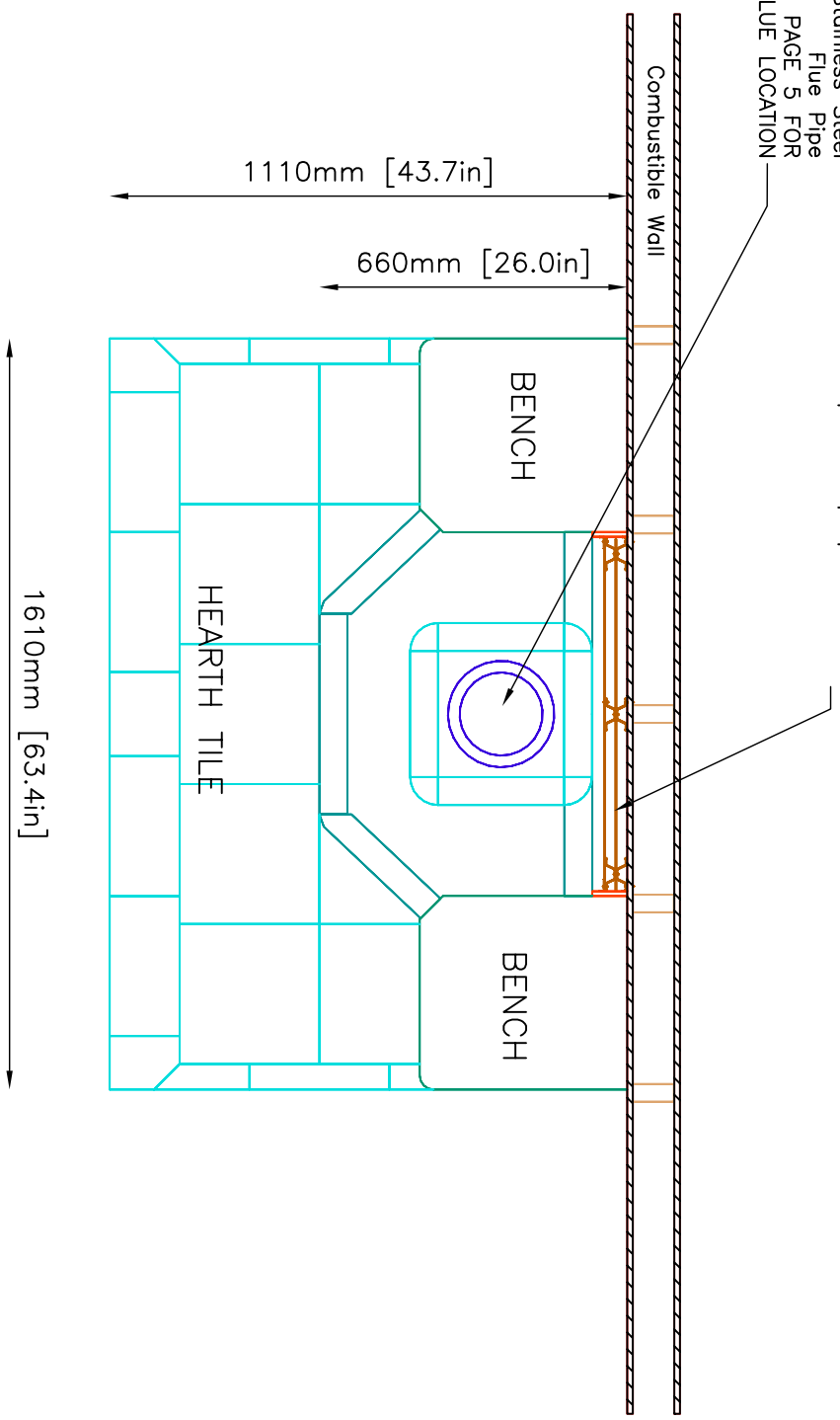

INFORMATION ONLY

REQUIRED:
Tulikivi's UL Listing requires minimum non-combustible hearth extension of 16" in front of the firebox door and 8" beyond either side of the firebox door.
Shown: Tulikivi Soapstone Tile. CUT AND INSTALLED by others